

MÓDULO TORRE QUENTE 70CM / MODULE HOT TOWER 70CM / MÓDULO DE TORRE CALIENTE 70CM
PH-3042

Montagem

Recomenda-se a leitura prévia das instruções de montagem e profissionais especializados para montar.

Assistência

Caso ocorra problema com algum dos componentes, sublinhe-o, identifique o problema e retorne esta relação, via fax ou outro meio de comunicação disponível para o representante.

Assinatura do cliente

Assembly

Before the assembling is recommended to read carefully the assembly instruction by professional assemblers.

Assistance

If happen problems with any component, underline the same, identify the problem and send back this relation immediately, by fax or other way.

Client signature

Montaje

Se recomienda la lectura previa de las instrucciones de montaje y profesionales especializados para montarlos.

Assistencia

Caso sucedan problemas con alguno de los componentes, subraye el componente, identifique el problema, y retorne esta copia via fax u otro medio de comunicación posible.

Assinatura del cliente

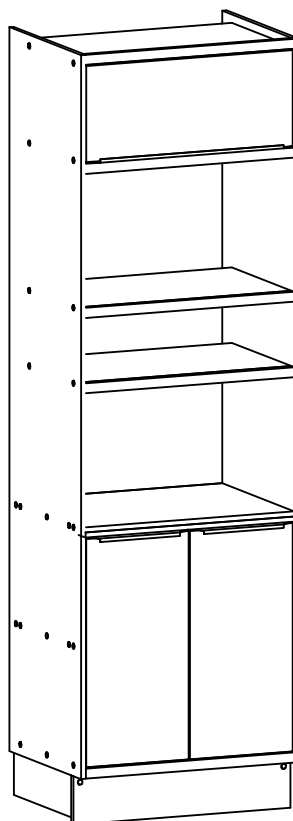

Atenção / Attention / Atención

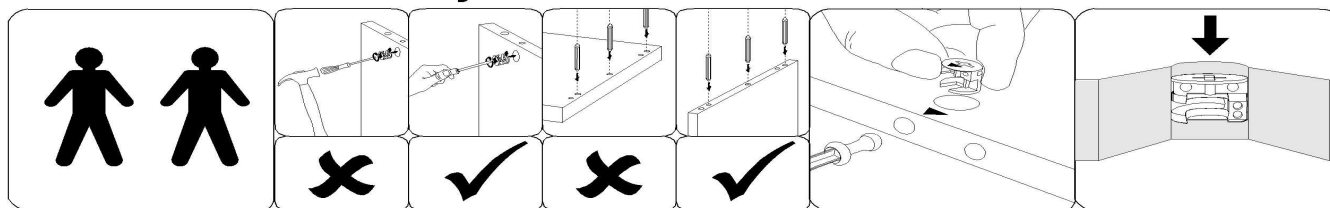

A Herval se reserva o direito de efetuar alterações nos produtos de suas linhas sem aviso prévio, quando entender necessário.

Herval reserves the right to effect modifications in the products, without previous advice, when understand necessary.

Herval se reserva el derecho de hacer las modificaciones que juzgue necesarias en sus productos, sin aviso previo, cuando lo crea necesario.

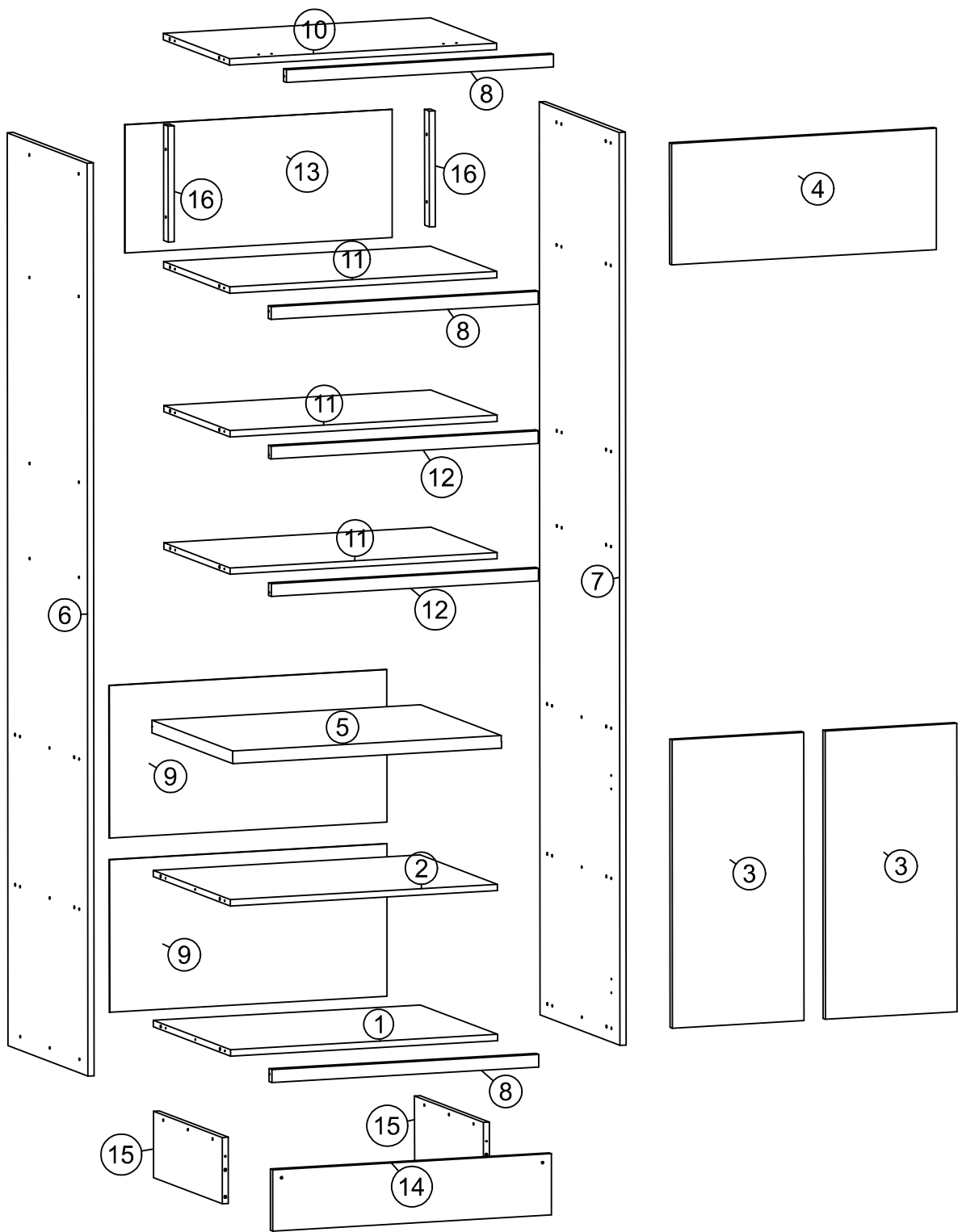
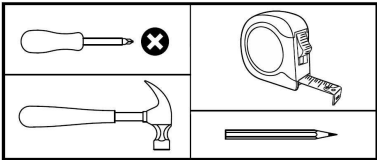

LISTA DE PEÇAS / PARTS LIST / LISTA DE PIEZAS

Volume 1

ÍNDICE / INDEX	CÓD. / CODE / COD	PEÇA / PART / PIEZA	MED/MEASURE/MED	QTDE / QUANTITY
1	158708E	BASE	670.0x501.0x15.0	1
2	158693E	PRATELEIRA	670.0x501.0x15.0	1
3	158692E	PORTA	682.0x330.0x15.0	2
4	158694E	PORTA BASCULANTE	287.0x664.0x15.0	1
5	F3042	TAMPO 30MM	674.0x520.0x30.0	1
17	1608483	PUXADOR EVOLUTO MAXI C- 2F CHAMP 330MM	xx	2
18	1608486	PUX. EVOLUTO MAXI 664 C- 4F CHAMPANHE	xx	1
78	1600008	PISTAO A GAS 60N	xx	2
-	K072570	KIT ACESSÓRIOS	xx	1
-	K072571	KIT DOBRADIÇAS	-	2

Volume-2

ÍNDICE / INDEX	CÓD. / CODE / COD	PEÇA / PART / PIEZA	MED/MEASURE/MED	QTDE / QUANTITY
6	158698E	LATERAL ESQUERDA	2160.0x520.0x15.0	1
7	158699E	LATERAL DIREITA	2160.0x520.0x15.0	1
8	158700E	VISTA FRONTAL MÉDIA	670.0x30.0x18.0	3
9	158701E	FUNDO	696.0x361.0x3.0	2
10	158702E	TAMPO	670.0x430.0x15.0	1
11	158703E	PRATELEIRA SUPERIOR	670.0x430.0x15.0	3
12	158704E	VISTA FRONTAL	670.0x30.0x18.0	2
13	158705E	FUNDO SUPERIOR	670.0x303.0x3.0	1
14	158706E	RODAPÉ FRENTE	699.0x145.0x15.0	1
15	158663E	RODAPÉ LATERAL	447.0x157.0x15.0	2
16	158707E	SUPORTE FUNDO	274.0x30.0x15.0	2

LISTA DE ACESSÓRIOS / FITTINGS LIST / LISTA DE ACCESORIOS

REF.	PEÇA	PART	PIEZA	QTDE	CÓDIGO
A	BUCHA 8mm	BUCHE 8mm	TARUGO 8mm	4	1602625
B	CANTONEIRA 18x18 (ZB)	CORNER 18x18mm	CANTONERA 18x18mm	8	1604301
C	PARAFUSO 3.5 X 14 CAB. CHATA PHILIPS	Screw Ø3.5 x 14 mm	Tornilo Ø3.5 x 14 mm	10	1607861
D	CAVILHA DE MADEIRA 6X40	Dowel Ø6 x 40 mm	Tarugo Ø6 x 40 mm	32	1604742
E	FIXADOR PARA COSTAS ZINCO BR	Back Panel Bracket	Soporte Panel Trasero	6	1601469
F	PARAFUSO 3.5 X 12 CAB.FLANGEADO ZB	TORNILLO 3.5 X 12 FL (ZB)	SCREW 3.5 X 12 FL (ZB)	30	3.5x12
G	PARAFUSO 4 X 25 CAB. FLANGEADO	SCREW Ø4 x 25 mm	TORNILLO Ø4 x 25 mm	10	4x25
H	PARAFUSO 4 X 14 CAB. CHATA REBAIXADA PHILIPS	Screw Ø4 x 14 mm	Tornilo Ø4 x 14 mm	28	1602420
I	PARAFUSO 4 X 25 CAB. CHATA PHILIPS	Screw Ø4 x 25 mm	Tornilo Ø4 x 25 mm	8	1607862
J	PARAFUSO 4 X 40 CAB. CHATA PHILIPS	Screw Ø4 x 40 mm	Tornilo Ø4 x 40 mm	36	1604937
K	PARAFUSO 6 X 60 CAB. FLANGEADO	SCREW Ø6 x 60 mm	TORNILLO Ø6 x 60 mm	4	1606857
L	PREGO 10 X 10 C/CABEÇA - Ø1,5 x 23mm	NAIL 10X10 - 1,5X23mm	CLAVO 10X10 - 1,5X23mm	48	1605365
M	PROTECAO SUPORTE FIXAÇÃO AÉREO	PROTECTINO SUPPORT AIRSPACE	PROTECCIÓN SOPORTE DE AÉREO	4	-
N	SAPATA NIQUELADA 20mm	20mm NICKEL SHOE	ZAPATO NIQUEL 20mm	4	-
O	SUPORTE ANGULAR	ANGLE SUPPORT	SOPORTE ANGULAR	15	-
P	SUPORTE FIXAÇÃO AÉREO	AIR SUPPORT FIXING	APOYO FIJACION AIRE	4	-
Q	TAPA FURO ADESIVO PAPEL 15mm	15mm HOLES COVER ADHESIVE	ADESIVO TAPA HUECO 15mm	44	-
R	SAQUINHO COLA BRANCA 10G	GLUE 10g	PEGAMENTO 10g	2	1605372

KIT DOBRADIÇAS / HINGES KIT / KIT BISAGRAS

REF.	PEÇA	PART	PIEZA	QTDE	CÓDIGO
H	PARAFUSO 4 X 14 CAB. CHATA REBAIXADA PHILIPS	Screw Ø4 x 14 mm	Tornilo Ø4 x 14 mm	36	1602420
S	CALÇO DOB. ALTA (4115402991)	SHIM HINGE	CUÑA BISAGRA	2	-
T	CALÇO H5 DOBRADIÇA AMORTECIMENTO	SHIM HINGE H5	CUÑA BISAGRA H5	4	-
U	DOB. ALTA AMORT 35MM (4115402991)	HIGH HINGE 35MM	BISAGRA ALTA 35MM	2	4115402991
V	DOB. SUP.ALTA AMORT 35MM (4115592996)	SUPER HIGH HINGE 35MM	BISAGRA SUPER ALTA 35MM	4	4115592996

**PASSO 1
STEP 1
PASO 1**

PEÇAS NECESSÁRIAS
PARTS REQUIRED
PIEZAS NECESSARIAS

INDICE	QUANT.
1	1
2	1
5	1
10	1
11	3
15	2

FERRAGEM NECESSÁRIA
HARDWARE REQUIRED
HERRAMIENTA NECESSARIA

QTDE	IMAGEM	INDICE
32		D

FERRAMENTAS NECESSÁRIAS
TOOL REQUIRED
HERRAMIENTA NECESSARIA

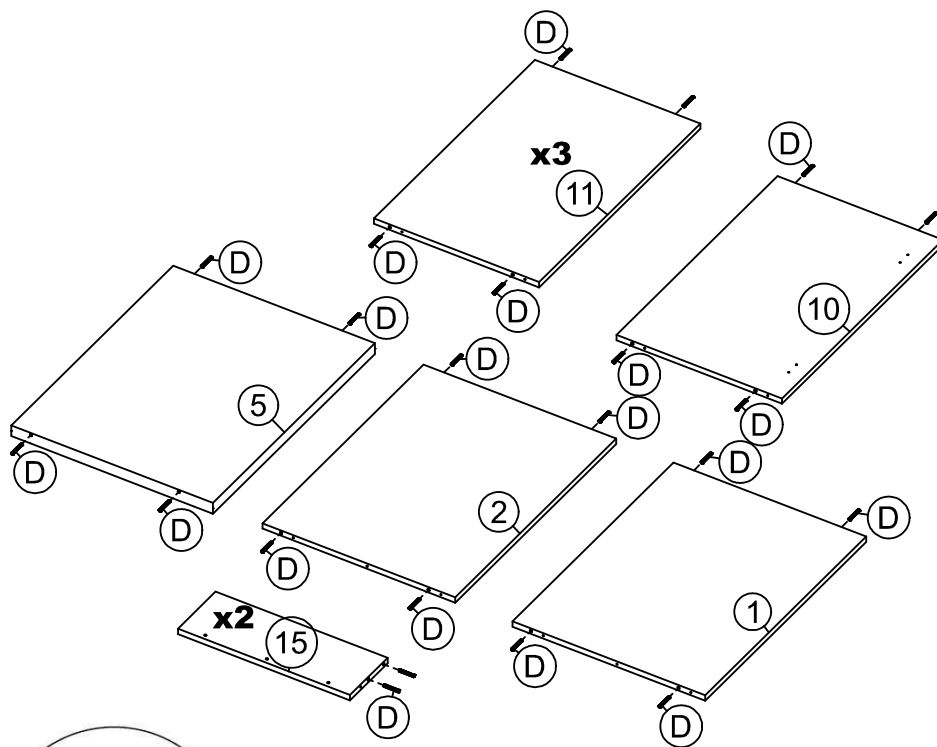
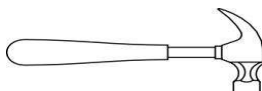



**PASSO 2
STEP 2
PASO 2**

PEÇAS NECESSÁRIAS
PARTS REQUIRED
PIEZAS NECESSARIAS

INDICE	QUANT.
1	1
2	1
5	1
6	1
10	1
11	3

FERRAGEM NECESSÁRIA
HARDWARE REQUIRED
HERRAMIENTA NECESSARIA

QTDE	IMAGEM	INDICE
17		J
17		Q

FERRAMENTAS NECESSÁRIAS
TOOL REQUIRED
HERRAMIENTA NECESSARIA

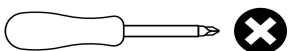

LADO COM BORDA
SIDE WITH EDGE
LADO CON BORDE

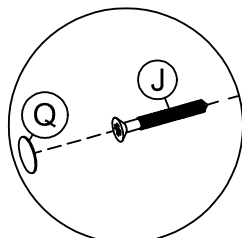
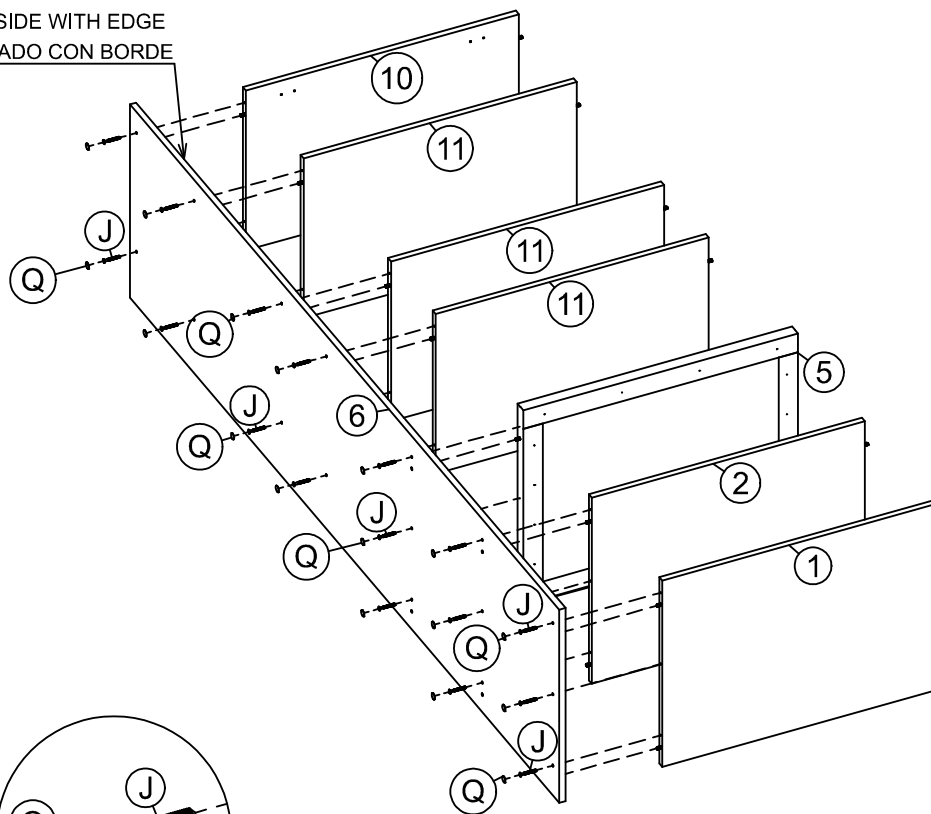

**PASSO 3
STEP 3
PASO 3**

PEÇAS NECESSÁRIAS
PARTS REQUIRED
PIEZAS NECESARIAS

INDICE	QUANT.
7	1

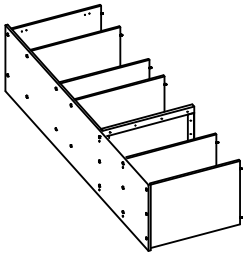

FERRAGEM NECESSÁRIA
HARDWARE REQUIRED
HERRAMIENTA NECESARIA

QTDE	IMAGEM	INDICE
17		J
17		Q

FERRAMENTAS NECESSÁRIAS
TOOL REQUIRED
HERRAMIENTA NECESARIA

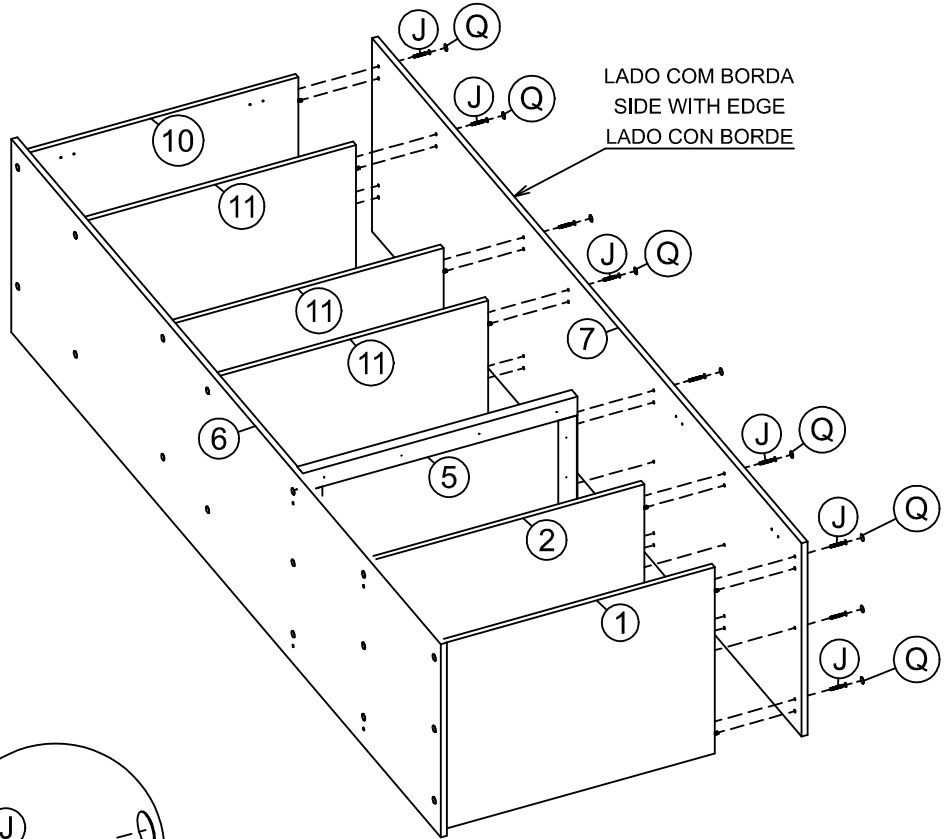
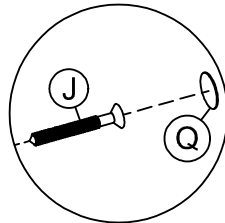
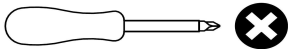

**PASSO 4
STEP 4
PASO 4**

PEÇAS NECESSÁRIAS
PARTS REQUIRED
PIEZAS NECESARIAS

INDICE	QUANT.
16	2

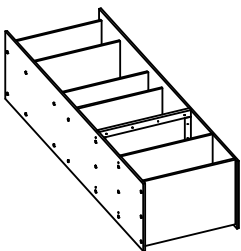

FERRAGEM NECESSÁRIA
HARDWARE REQUIRED
HERRAMIENTA NECESARIA

QTDE	IMAGEM	INDICE
4		G

FERRAMENTAS NECESSÁRIAS
TOOL REQUIRED
HERRAMIENTA NECESARIA

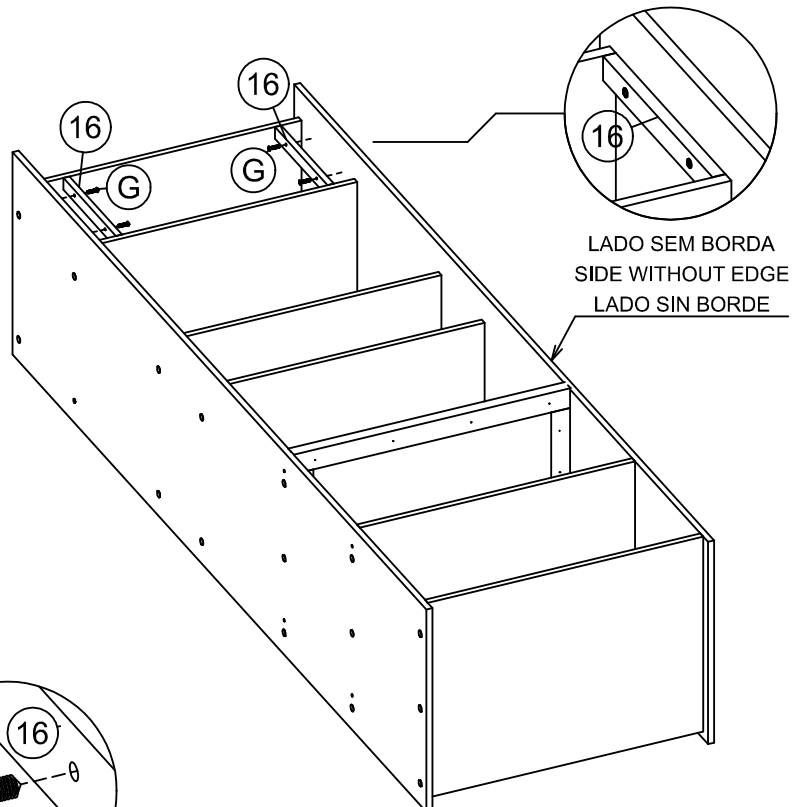
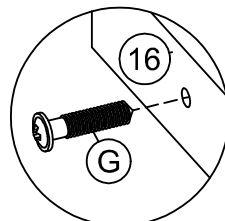
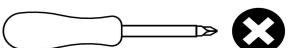

PASSO 5
STEP 5
PASO 5

PEÇAS NECESSÁRIAS
PARTS REQUIRED
PIEZAS NECESARIAS

INDICE	QUANT.
9	2
13	1

FERRAGEM NECESSÁRIA
HARDWARE REQUIRED
HERRAMIENTA NECESSARIA

QTDE	IMAGEM	INDICE
6		E
48		L

FERRAMENTAS NECESSÁRIAS
TOOL REQUIRED
HERRAMIENTA NECESSARIA

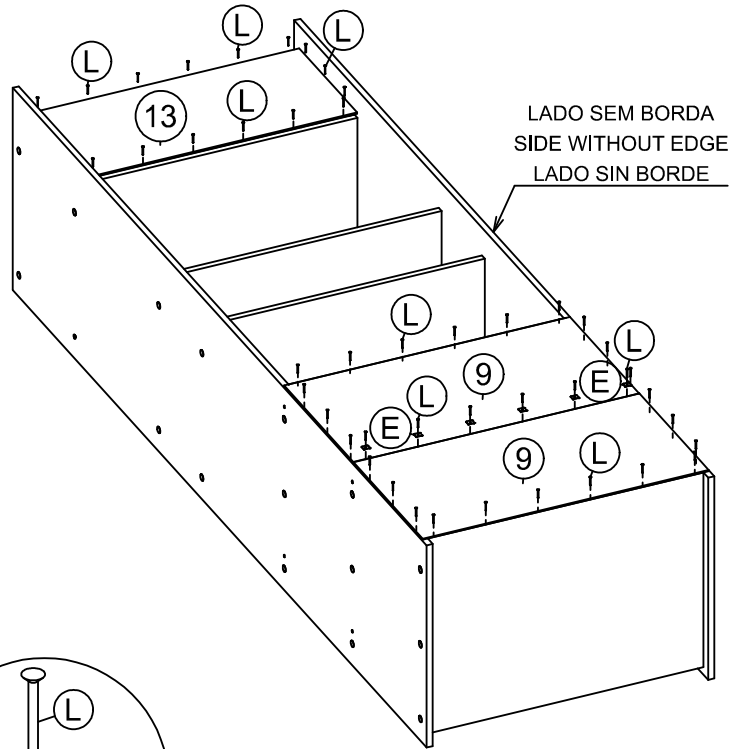
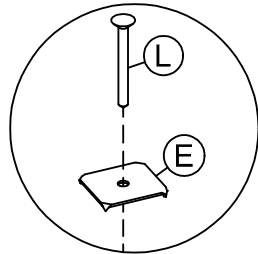
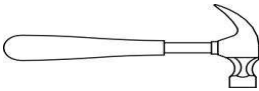

PASSO 6
STEP 6
PASO 6

PEÇAS NECESSÁRIAS
PARTS REQUIRED
PIEZAS NECESARIAS

INDICE	QUANT.
8	3
12	2

FERRAGEM NECESSÁRIA
HARDWARE REQUIRED
HERRAMIENTA NECESSARIA

QTDE	IMAGEM	INDICE
15		F
15		O

FERRAMENTAS NECESSÁRIAS
TOOL REQUIRED
HERRAMIENTA NECESSARIA

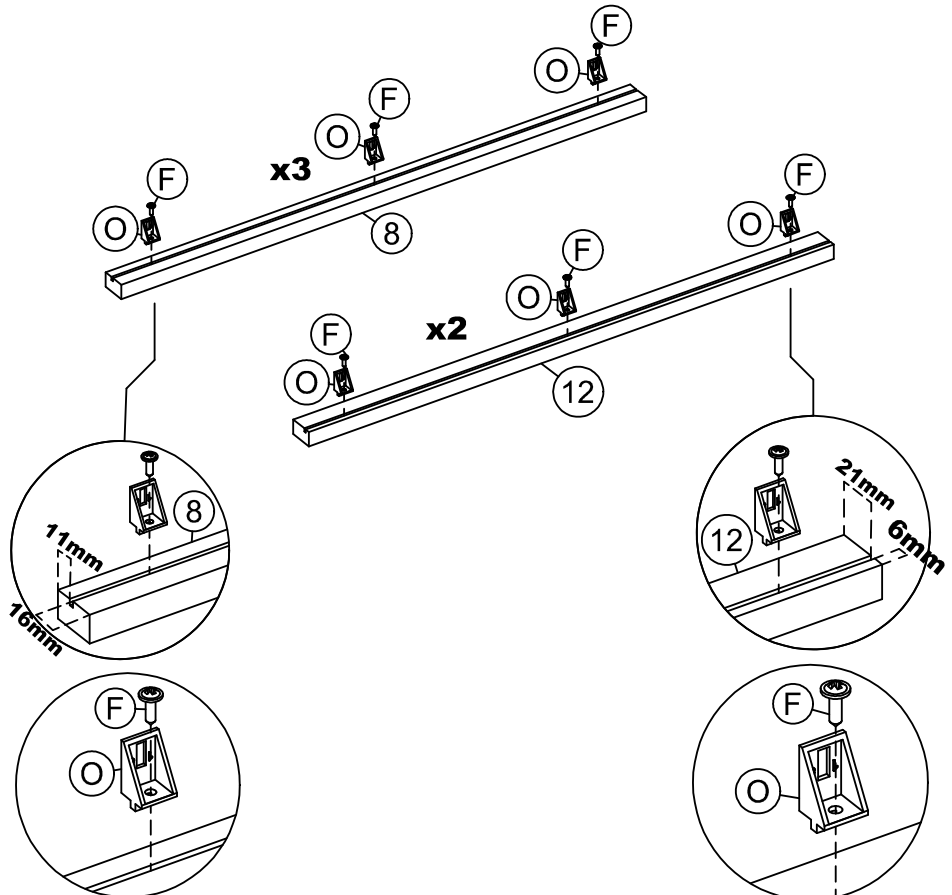
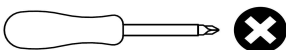

PASSO 7
STEP 7
PASO 7

PEÇAS NECESSÁRIAS
PARTS REQUIRED
PIEZAS NECESARIAS

INDICE	QUANT.
8	3
12	2

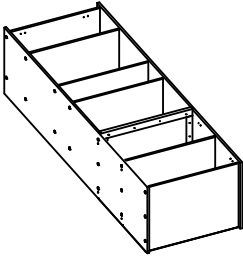

FERRAGEM NECESSÁRIA
HARDWARE REQUIRED
HERRAMIENTA NECESSARIA

QTDE	IMAGEM	INDICE
15		F

FERRAMENTAS NECESSÁRIAS
TOOL REQUIRED
HERRAMIENTA NECESSARIA

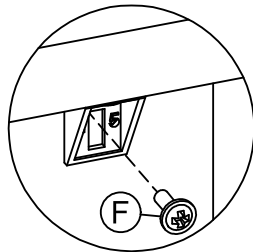
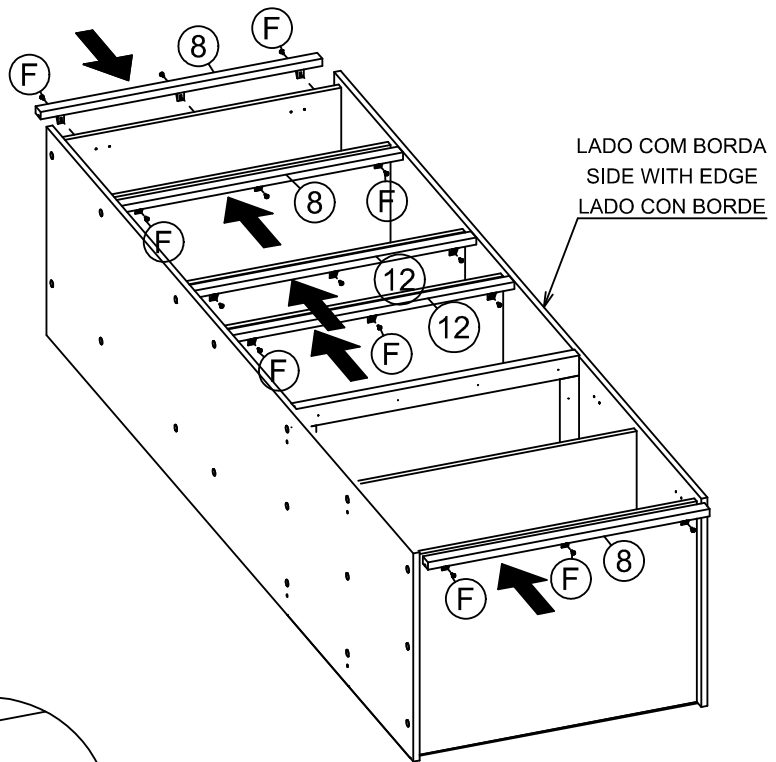
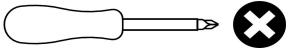

PASSO 8
STEP 8
PASO 8

PEÇAS NECESSÁRIAS
PARTS REQUIRED
PIEZAS NECESARIAS

FERRAGEM NECESSÁRIA
HARDWARE REQUIRED
HERRAMIENTA NECESSARIA

QTDE	IMAGEM	INDICE
8		B
16		H

FERRAMENTAS NECESSÁRIAS
TOOL REQUIRED
HERRAMIENTA NECESSARIA

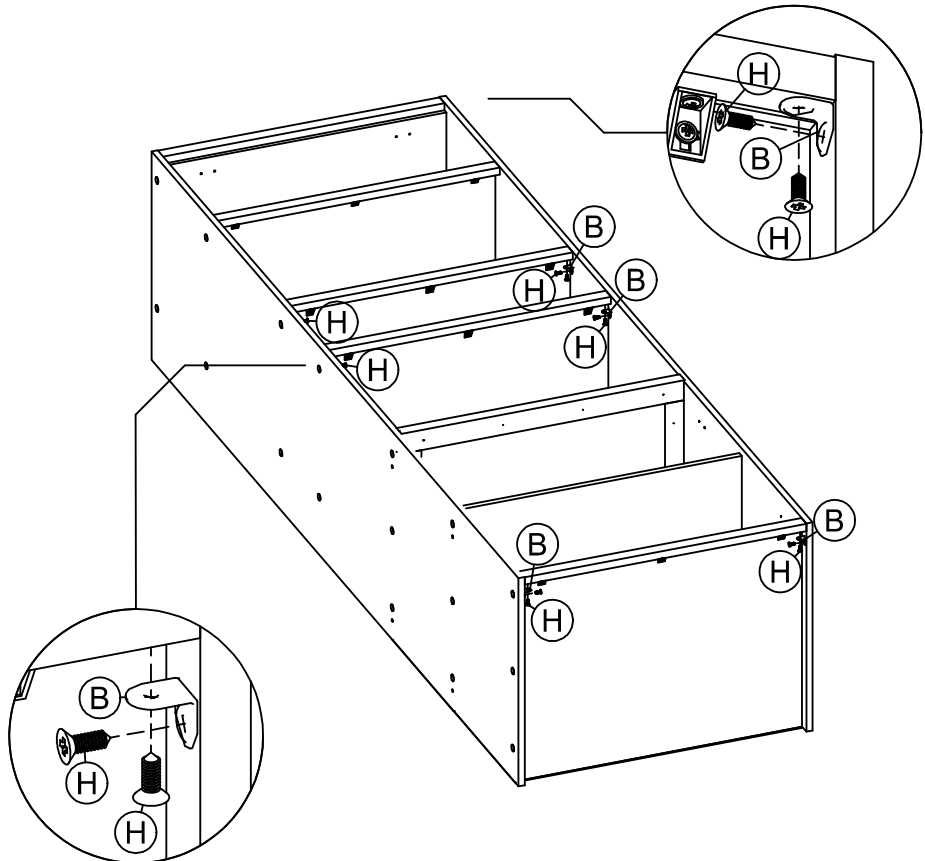
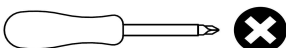



PASSO 9
STEP 9
PASO 9

PEÇAS NECESSÁRIAS
PARTS REQUIRED
PIEZAS NECESARIAS

INDICE	QUANT.
14	1
15	2

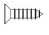
FERRAGEM NECESSÁRIA
HARDWARE REQUIRED
HERRAMIENTA NECESARIA

QTDE	IMAGEM	INDICE
2		J
4		N
2		Q

FERRAMENTAS NECESSÁRIAS
TOOL REQUIRED
HERRAMIENTA NECESARIA

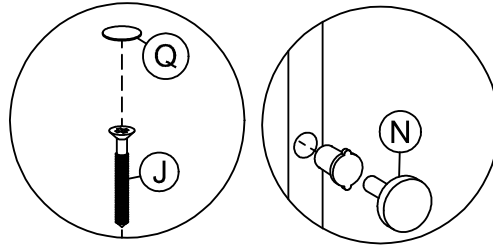
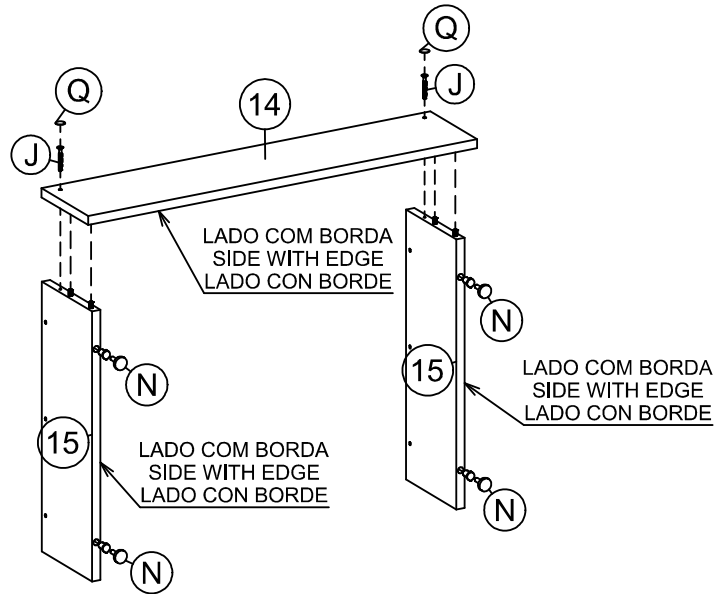
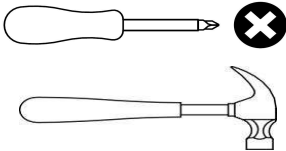

PASSO 10
STEP 10
PASO 10

PEÇAS NECESSÁRIAS
PARTS REQUIRED
PIEZAS NECESARIAS

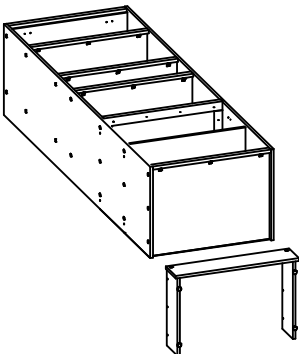

FERRAGEM NECESSÁRIA
HARDWARE REQUIRED
HERRAMIENTA NECESARIA

QTDE	IMAGEM	INDICE
6		G

FERRAMENTAS NECESSÁRIAS
TOOL REQUIRED
HERRAMIENTA NECESARIA

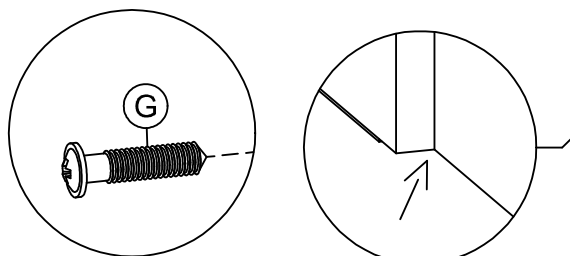
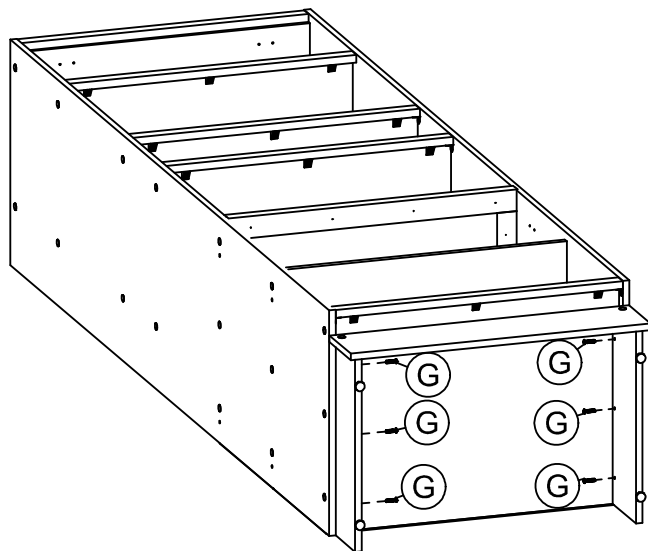
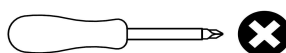







FACEAR COM A PARTE TRASEIRA DO MÓVEL.
FACE WITH THE BACK OF THE FURNITURE.
CARA CON LA PARTE POSTERIOR DEL MUEBLE.

PASSO 11
STEP 11
PASO 11

PEÇAS NECESSÁRIAS
PARTS REQUIRED
PIEZAS NECESARIAS

FERRAGEM NECESSÁRIA
HARDWARE REQUIRED
HERRAMIENTA NECESARIA

QTDE	IMAGEM	INDICE
4		A
28		H
8		I
4		K
4		M
4		P

FERRAMENTAS NECESSÁRIAS
TOOL REQUIRED
HERRAMIENTA NECESARIA

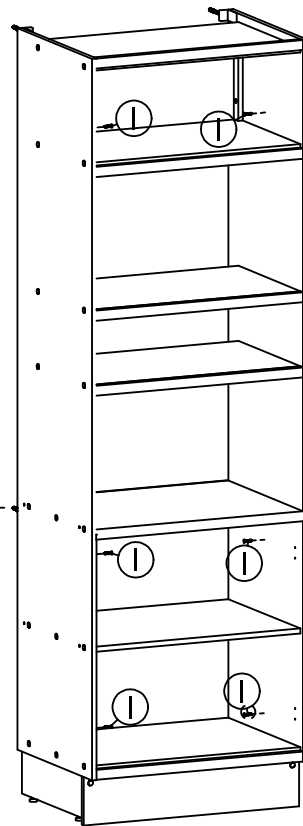
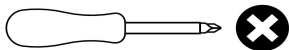

x4

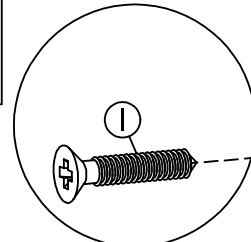
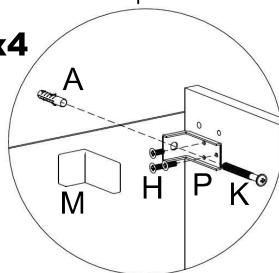

Acessórios usados para fixar o móvel na parede.
Accessories used to fix the furniture to the wall.
Accesorios utilizados para fijar los muebles a la pared





Parafusos usados para unir um módulo ao outro.
Screws used to attach one module to another.
Tornillos utilizados para unir un módulo a otro.

PASSO 12
STEP 12
PASO 12

PEÇAS NECESSÁRIAS
PARTS REQUIRED
PIEZAS NECESARIAS

INDICE	QUANT.
3	2
4	1
17	2
18	1

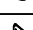
FERRAGEM NECESSÁRIA
HARDWARE REQUIRED
HERRAMIENTA NECESARIA

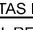
QTDE	IMAGEM	INDICE
10		C
12		H
2		S
4		T
2		U
4		V

FERRAMENTAS NECESSÁRIAS
TOOL REQUIRED
HERRAMIENTA NECESARIA

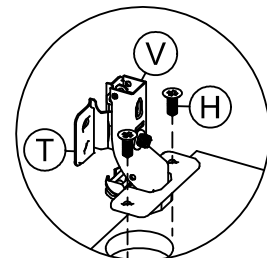
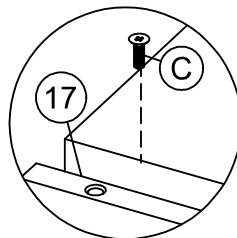
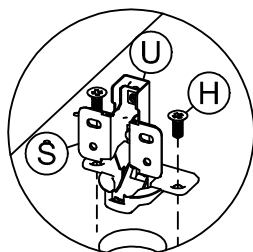
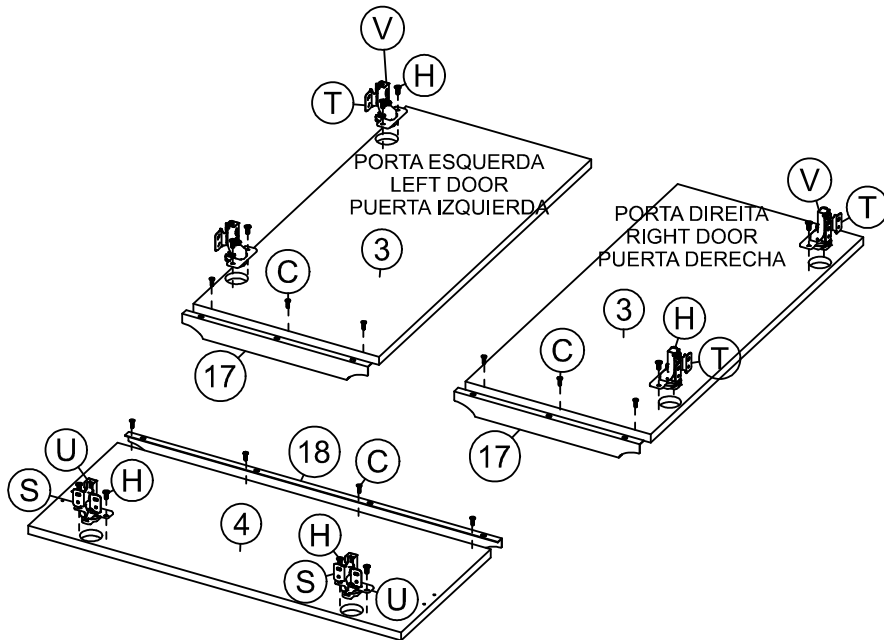
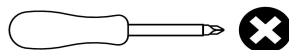



PASSO 13
STEP 13
PASO 13

PEÇAS NECESSÁRIAS
PARTS REQUIRED
PIEZAS NECESARIAS

INDICE	QUANT.
3	2
4	1

FERRAGEM NECESSÁRIA
HARDWARE REQUIRED
HERRAMIENTA NECESARIA

QTDE	IMAGEM	INDICE
24		H
8		Q

FERRAMENTAS NECESSÁRIAS
TOOL REQUIRED
HERRAMIENTA NECESARIA

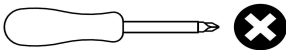

Montagem e ajuste das Dobradiças.
Assembly and adjustment of the Hinges.
Montaje y ajuste de las Bisagras.

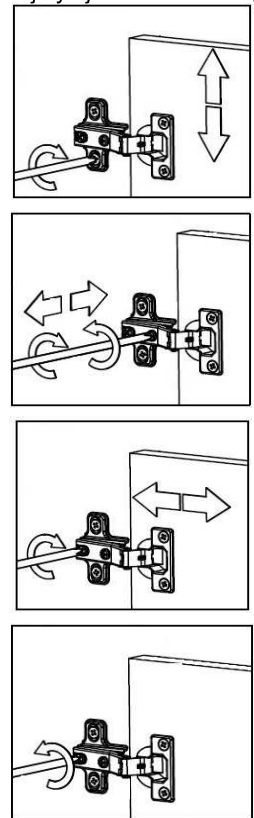
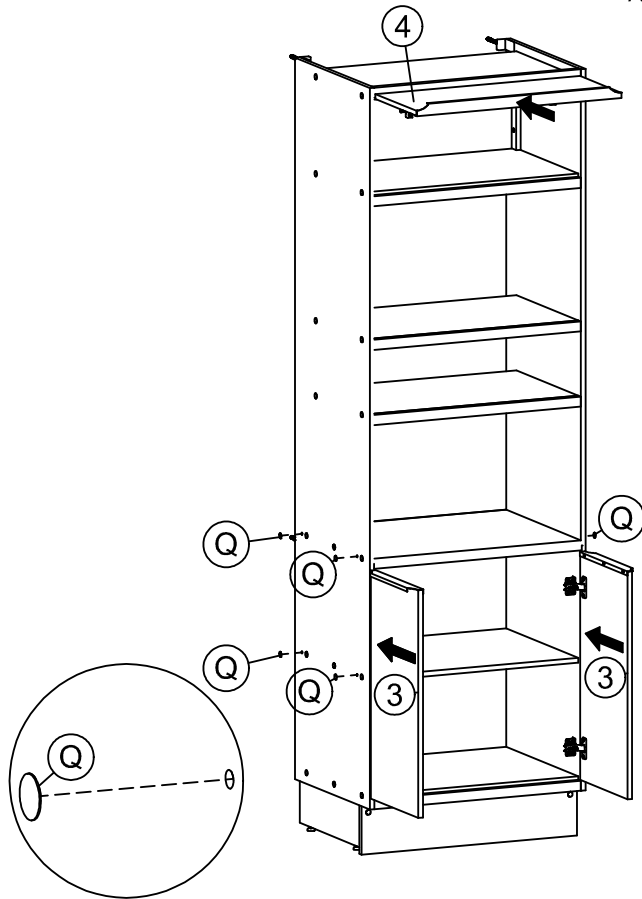

PASSO 14
STEP 14
PASO 14

PEÇAS NECESSÁRIAS
PARTS REQUIRED
PIEZAS NECESARIAS

INDICE	QUANT.
78	2

FERRAGEM NECESSÁRIA
HARDWARE REQUIRED
HERRAMIENTA NECESARIA

FERRAMENTAS NECESSÁRIAS
TOOL REQUIRED
HERRAMIENTA NECESARIA

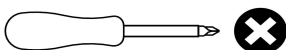

Atenção / attentió / Atención

Para fazer a montagem do Pistão à gás (78) usar o manual que acompanha o componente.
To assemble the Gas Piston (78), use the manual that comes with the component.
Para ensamblar el Pistón de Gas (78), utilice el manual que viene con el componente.

