

# Roupeiro / Ropero / Wardrobe PETROPOLIS BC-3390

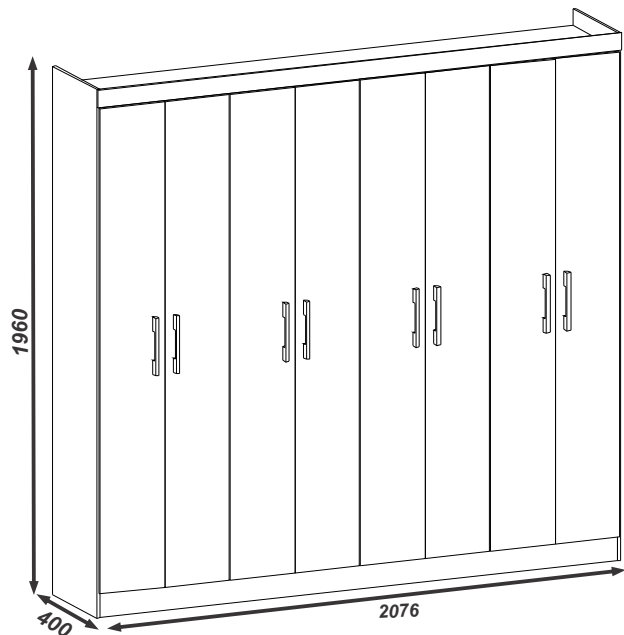

**Instruções para a montagem do produto:**  
**Product assembly instructions:**  
**Instrucciones de montaje del Producto:**



**■ Separe as peças e acessórios de maneira organizada.**  
Separate the parts and accessories in an organized way.  
Separe las piezas y accesorios de forma organizada.



**Forrar o chão com o papelão das embalagens.**  
Cover the floor with the cardboard from the pack.  
Cubre el suelo con el cartón de los bultos.



**É necessário duas pessoas para montar o produto.**  
It's necessary two people to assembly the product.  
Se requiere dos personas para montar el producto.

**Ferramentas necessárias**(não fornecidas)  
**Herrajes necesarias** (no incluye)  
**Necessary tools** (not supplied)

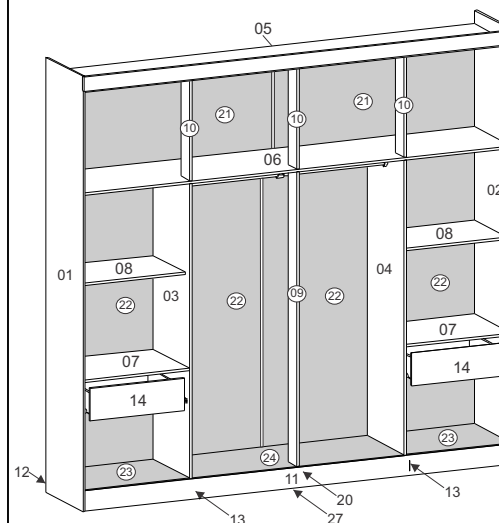
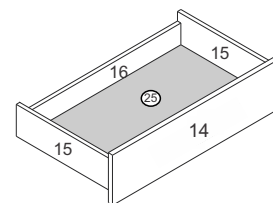
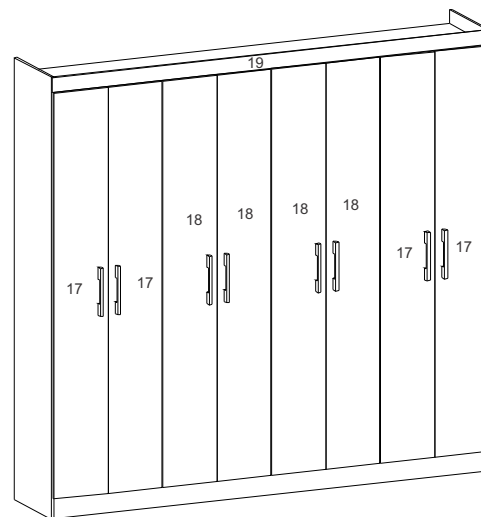

**DIMENSÕES PEÇAS PRONTAS**

01-LATERAL ESQUERDA	01-1960 X 386 X 12
02-LATERAL DIREITA	02-1960 X 386 X 12
03-DIVISÓRIA ESQUERDA	03-1363 X 385 X 12
04-DIVISÓRIA DIREITA	04-1363 X 385 X 12
05-TAMPO SUPERIOR	05-2052 X 385 X 12
06-TAMPO MALEIRO	06-2052 X 385 X 12
07-TAMPO DAS GAVETAS (2X)	07-504 X 384 X 12
08-PRATELEIRAS (2X)	08-504 X 337 X 12
09-PILAISTRA CENTRAL	09-1360 X 95 X 12
10-PILASTRAS SUPERIOR (3X)	10-417 X 95 X 12
11-RODAPÉ FRONTAL	11-2052 X 95 X 12
12-RODAPÉ TRASEIRO	12-2052 X 95 X 12
13-TRAVESSA DE RODAPÉ (2X)	13-358 X 65 X 12
14-FRENTE DE GAVETA (2x)	14-454 X 147 X 12
15-LATERAL DE GAVETA (4x)	15-338 X 95 X 12
16-TRASEIRO DE GAVETA (2x)	16-406 X 65 X 12
17-PORTAS LATERAIS (4x)	17-1802 X 255 X 12
18-PORTAS CENTRAIS (4x)	18-1802 X 255 X 12
19-FRONTAL	19-2077 X 65 X 12
20-TRAVESSA RODAPÉ CENTRAL	20-358 X 65 X 12
21-COSTA MALEIRO (2x)	21-1032 X 431 X 3
22-COSTAS (4x)	22-1375 X 516 X 3
23-TAMPO INFERIOR (2X)	23-504 X 385 X 3
24-TAMPO INFERIOR CENTRAL	24-1020 X 385 X 3
25-FUNDO DE GAVETA (2x)	25-428 X 341 X 3
27-TRAVESSA RODAPÉ CENTRAL	27-357 X 83 X 12

**DIMENSIONES DE LAS PEZAS PRONTAS**

01-LATERAL IZQUIERDA	01-1960 X 386 X 12
02-LATERAL DERECHA	02-1960 X 386 X 12
03-DIVISION IZQUIERDA	03-1363 X 385 X 12
04-DIVISION DERECHA	04-1363 X 385 X 12
05-TAPA SUPERIOR	05-2052 X 385 X 12
06-TAPA MALEIRO	06-2052 X 385 X 12
07-TAPA DEL CAJÓN (2X)	07-504 X 384 X 12
08-ESTANTE (2X)	08-504 X 337 X 12
09-PILAISTRA CENTRAL	09-1360 X 95 X 12
10-PILASTRAS SUPERIOR (3X)	10-417 X 95 X 12
11-ZÓCALO FRONTAL	11-2052 X 95 X 12
12-ZÓCALO TRASERO	12-2052 X 95 X 12
13-TRAVESAÑO DEL ZÓCALO (2X)	13-358 X 65 X 12
14-FRENTE DEL CAJÓN (2x)	14-454 X 147 X 12
15-LATERAL DEL CAJÓN (4x)	15-338 X 95 X 12
16-TRASERO DEL CAJÓN (2x)	16-406 X 65 X 12
17-PUERTAS LATERAIS (4x)	17-1802 X 255 X 12
18-PUERTAS CENTRAIS (4x)	18-1802 X 255 X 12
19-FRONTAL	19-2077 X 65 X 12
20-TRAVESAÑO DEL ZÓCALO CENTRAL	20-358 X 65 X 12
21-DORSO MALEIRO (2x)	21-1032 X 431 X 3
22-DORSO (4x)	22-1375 X 516 X 3
23-TAPA INFERIOR (2X)	23-504 X 385 X 3
24-TAPA INFERIOR CENTRAL	24-1020 X 385 X 3
25-FONDO DEL CAJÓN (2x)	25-428 X 341 X 3
27-TRAVESAÑO DEL ZÓCALO CENTRAL	27-357 X 83 X 12

**DIMENSIONS READY MODE PARTS**

01-LEFT SIDE	01-1960 X 386 X 12
02-RIGHT SIDE	02-1960 X 386 X 12
03-LEFT DIVIDER	03-1363 X 385 X 12
04-RIGHT DIVIDER	04-1363 X 385 X 12
05-UPPER TOP	05-2052 X 385 X 12
06-MALEIRO TOP	06-2052 X 385 X 12
07-DRAWER TOP (2X)	07-504 X 384 X 12
08-SHELF(2X)	08-504 X 337 X 12
09-CENTRAL PILASTER	09-1360 X 95 X 12
10-UPPER PILASTER (3X)	10-417 X 95 X 12
11-FRONT BASE BOARD	11-2052 X 95 X 12
12-BACK BASE BOARD	12-2052 X 95 X 12
13-BASE BOARD CROSSBAR (2X)	13-358 X 65 X 12
14-DRAWER FRONT(2x)	14-454 X 147 X 12
15-DRAWER SIDE (4x)	15-338 X 95 X 12
16-DRAWER BACK (2x)	16-406 X 65 X 12
17-SIDE DOOR (4x)	17-1802 X 255 X 12
18-CENTRAL DOOR(4x)	18-1802 X 255 X 12
19-FRONT	19-2077 X 65 X 12
20-CENTRAL BASE BOARD CROSSBAR	20-358 X 65 X 12
21-BACK PANEL MALEIRO (2x)	21-1032 X 431 X 3
22-BACK PANEL(4x)	22-1375 X 516 X 3
23-LOWER TOP(2X)	23-504 X 385 X 3
24-CENTRAL LOWER TOP	24-1020 X 385 X 3
25-DRAWER BOTTOM(2x)	25-428 X 341 X 3
27-BASE BOARD CROSSBAR CENTRAL	27-357 X 83 X 12

### Ferragem/Herraje/Hardware:

Cód	Itens	Quan
330	A Cavilhas 6 x 30 Clavija Bowel	20
0283	B Parafuso 3,5 x 12 c/c Tornillo Screw	172
0285	C Parafuso 3,5 x 25 c/ flangeado Tornillo Screw	16
0289	D Parafuso 3,5 x 40 c/c Tornillo Screw	44
0296	E Taxa 10 x 7 Clavo 10 x 7 Nail 10 x 7	130
0438	F Cantoneira Esquinera Cantoneira	21
0538	G Porca cilíndrica Tuerca cilíndrica Cylindrical nut	28
0279	H Fixador de costa Fixador de espalda Fix back	36
0744	I Taxa 13 x 15 Clavo 13 x 15 Nail 13 x 15	08
0286	J Parafuso 3,5 x 22 c/c Tornillo Screw	02
5159	K Cavilhas 6 x 50 Clavija Bowel	02
0645	L Pino suporte Prateleira 8x5,5 Soporte Support	10
151	M Dobradiça metal Bisagra Hinge	24
1413	N Suporte cabide sem furo CINZA Soporte percha Hanger holding	02
1415	O Suporte cabideiro Soporte percha Hanger holding	01
8054	P Distanciador Dobradiça Bisagra Hinge	24
-----	Q Puxador 192 mm Tirador Handle	08
0477	R Cola Pegamento Glue	01
5960	S Distanciador 25mm	08
3049	T Corrediça Metálica SLIM 350mm Rieles Slides	02
-----	U Cabideiro de madeira 1014 mm Perchero de madera Holding	01
-----	V Perfil 1360mm Perfil Profile	01
-----	X Sapata U 15 mm Pata Feet	08
-----	Z Perfil 417mm Perfil Profile	01

### Montagem da gaveta Armado de los cajones Drawer Assembly

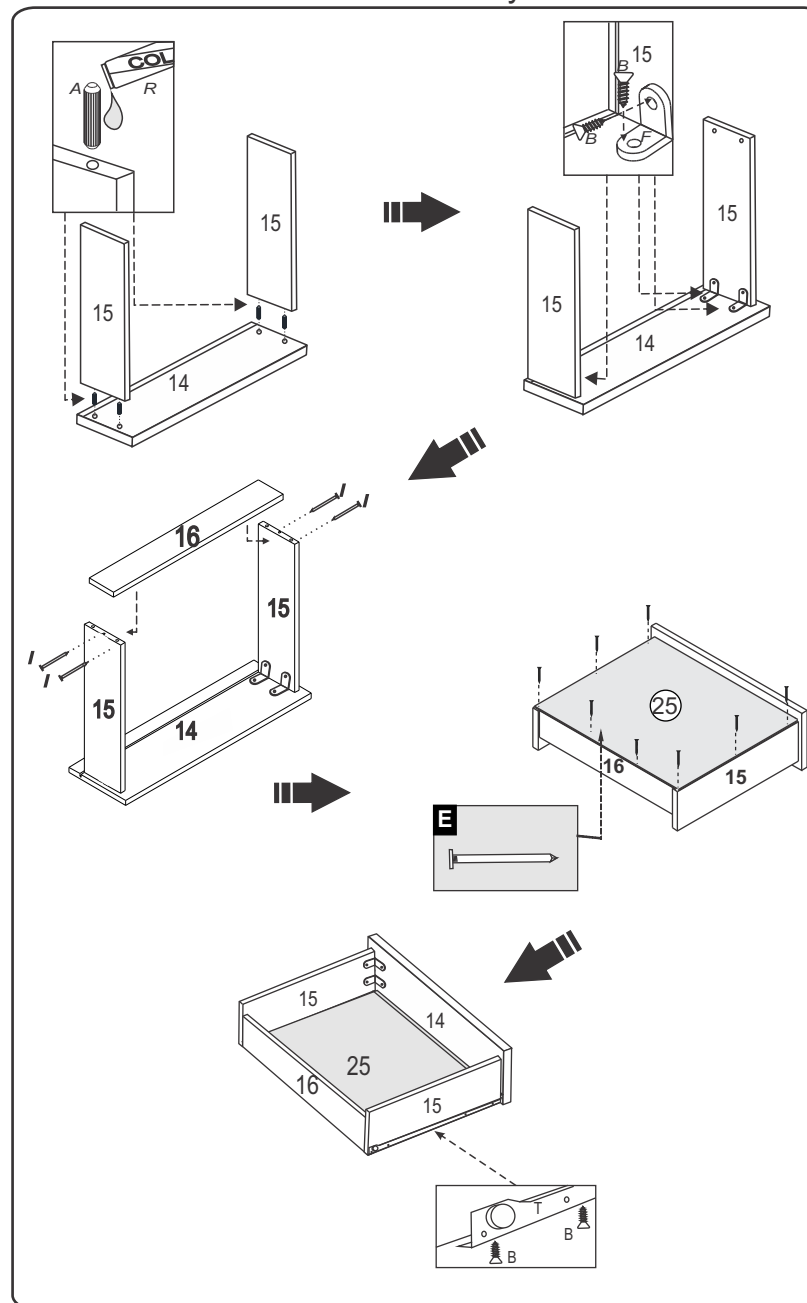

**1º Passo**  
**1º Paso**  
**1º Step**

Atenção! ao parafusar a corredeira,  
 ,cuidar o lado certo.

Atención! al atornillar la corredera,  
 cuidar para que esté en el lado correcto

Attention! When screwing the slide,  
 take care to do the right side

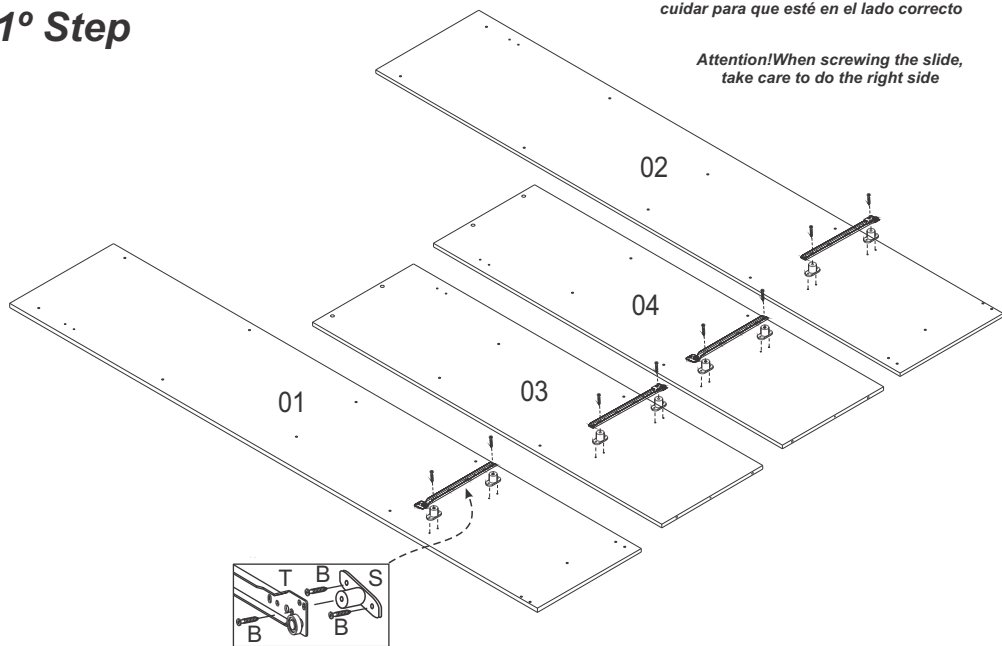

**2º Passo**  
**2º Paso**  
**2º Step**

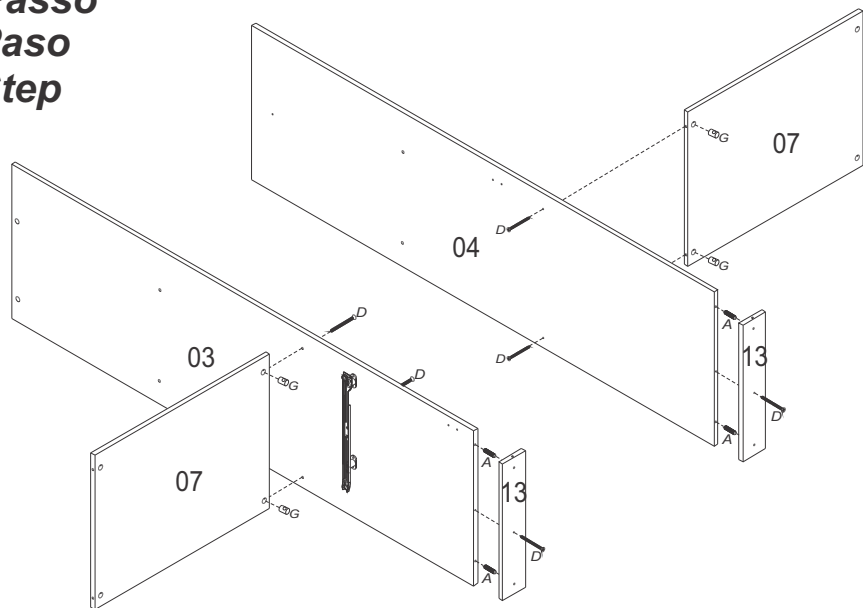

**3º Passo**  
**3º Paso**  
**3º Step**

Atenção!  
 Cavilha (K) diferente  
 para junção das peças  
**Clavija diferente**  
 para juntar las piezas  
 Different bolt for joining  
 the partes.

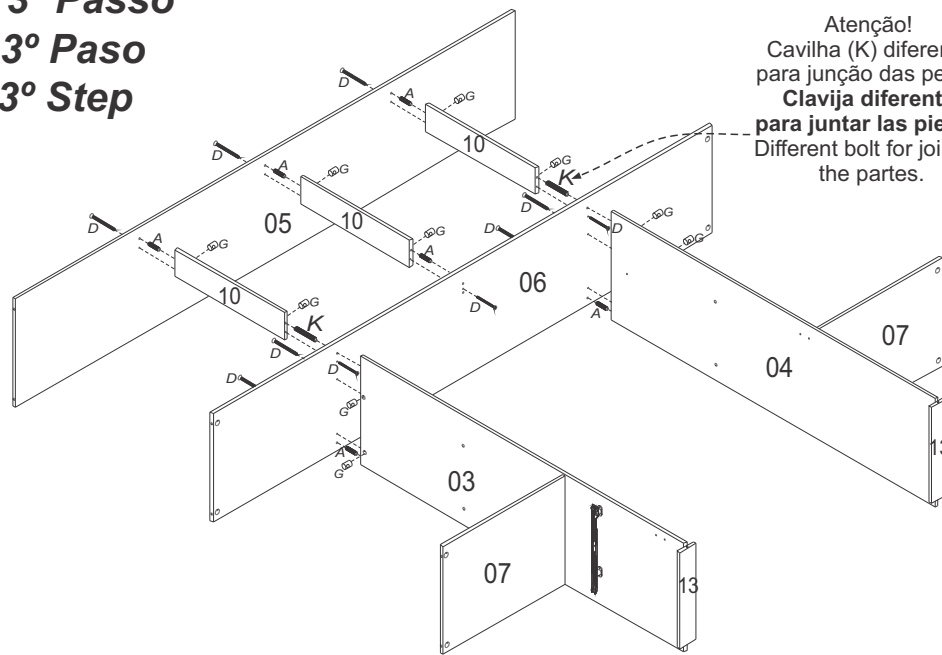

**4º Passo**  
**4º Paso**  
**4º Step**

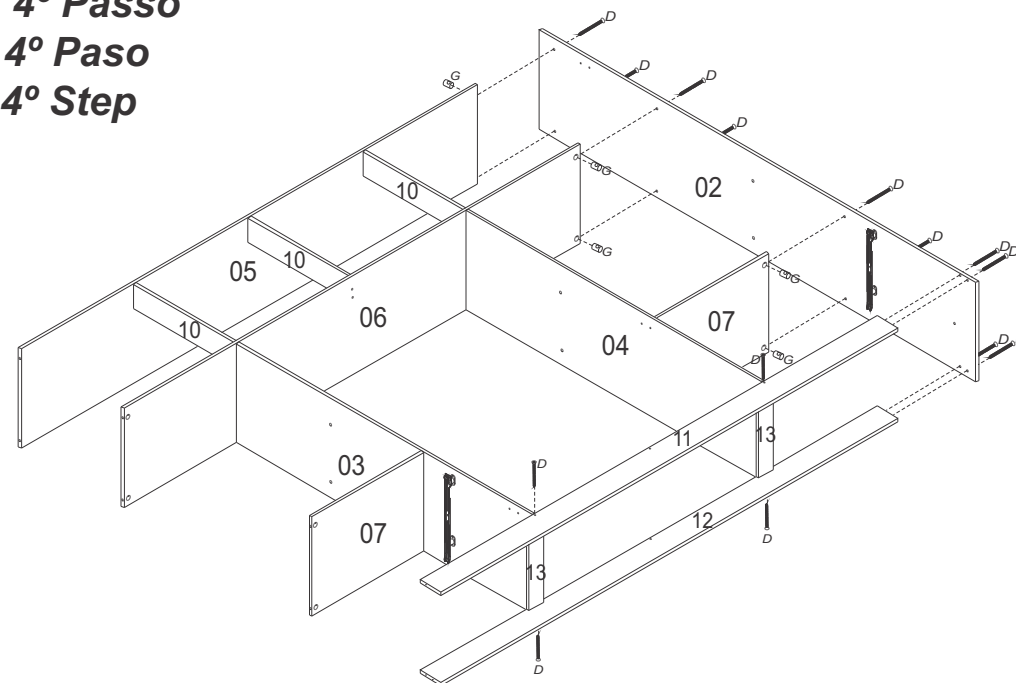

**5º Passo**  
**5º Paso**  
**5º Step**

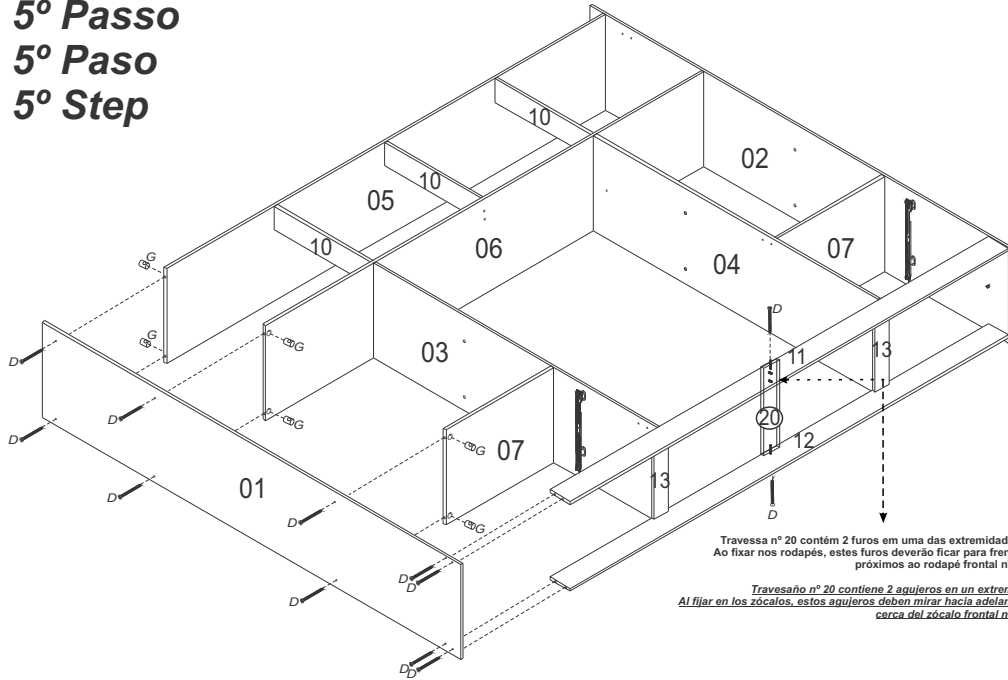

**6º Passo**  
**6º Paso**  
**6º Step**

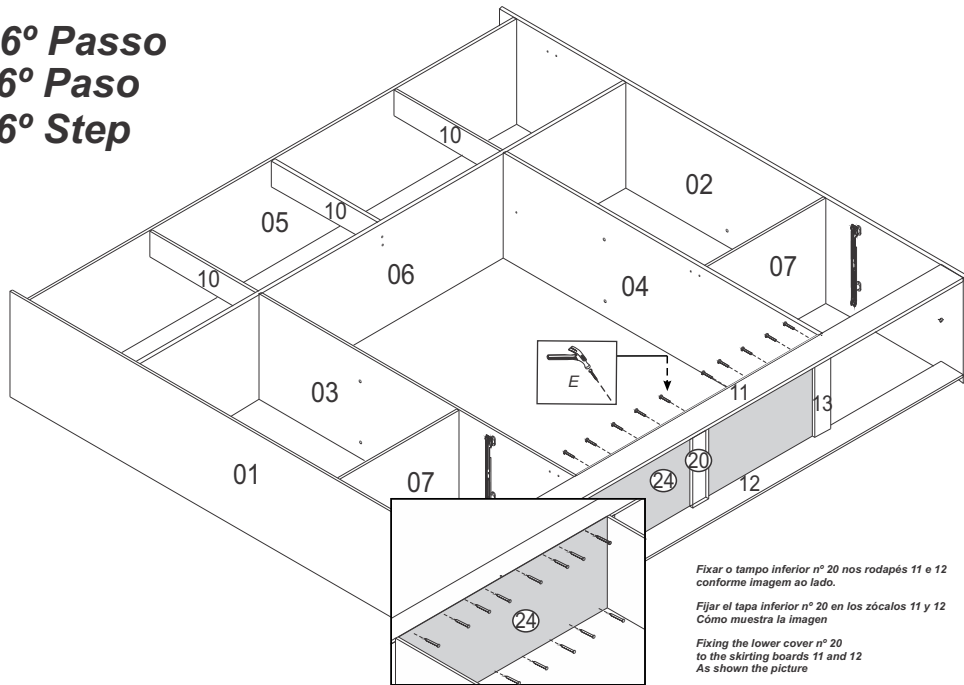

Vista Superior - Upper View - Vista arriba

**7º Passo**  
**7º Paso**  
**7º Step**

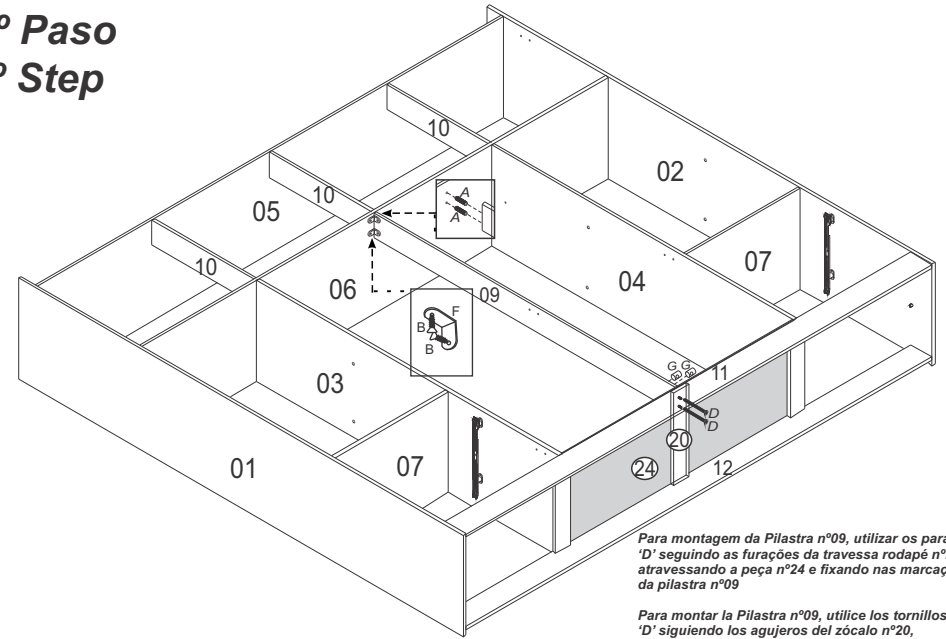

**8º Passo**  
**8º Paso**  
**8º Step**

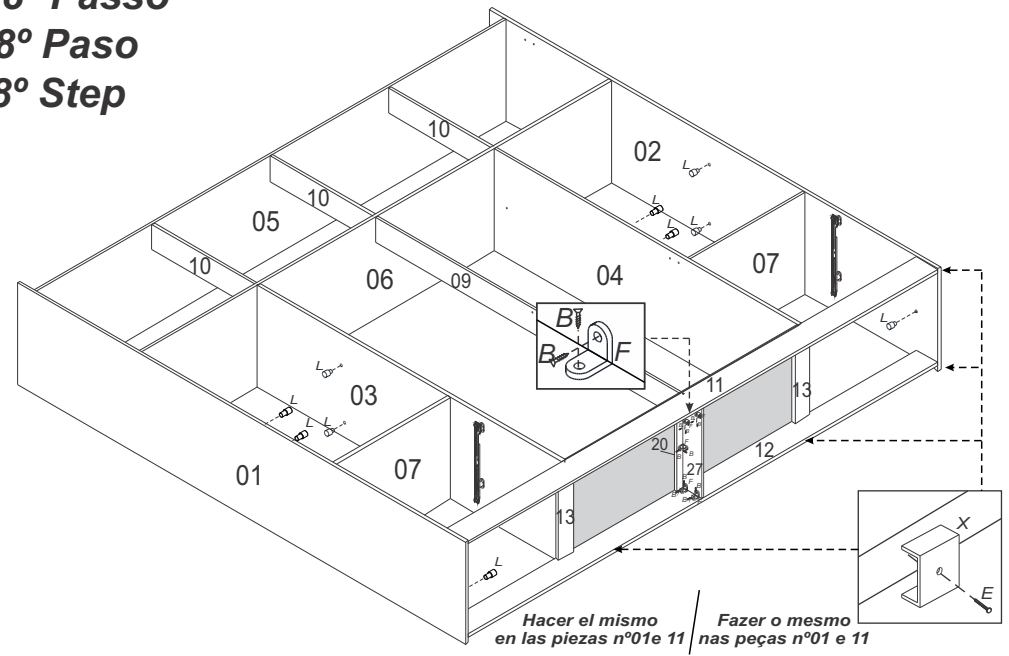

**9º Passo**  
**9º Paso**  
**9º Step**

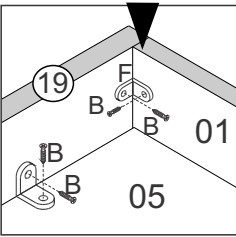
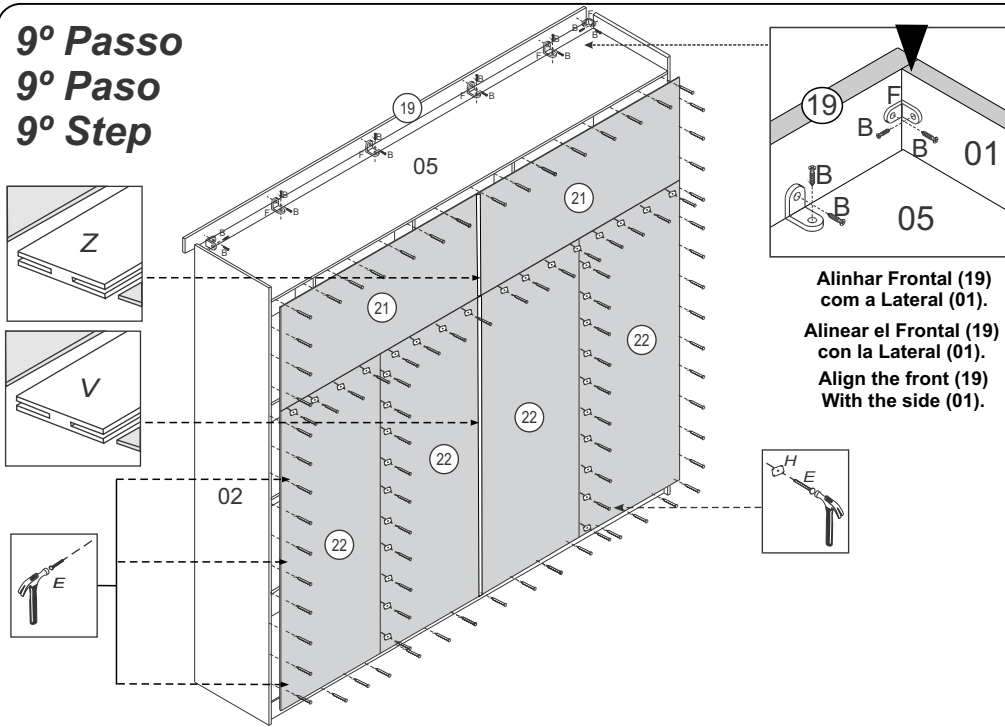

**Alinhar Frontal (19) com a Lateral (01).**  
**Alinear el Frontal (19) con la Lateral (01).**  
**Align the front (19) With the side (01).**

**10º Passo**  
**10º Paso**  
**10º Step**

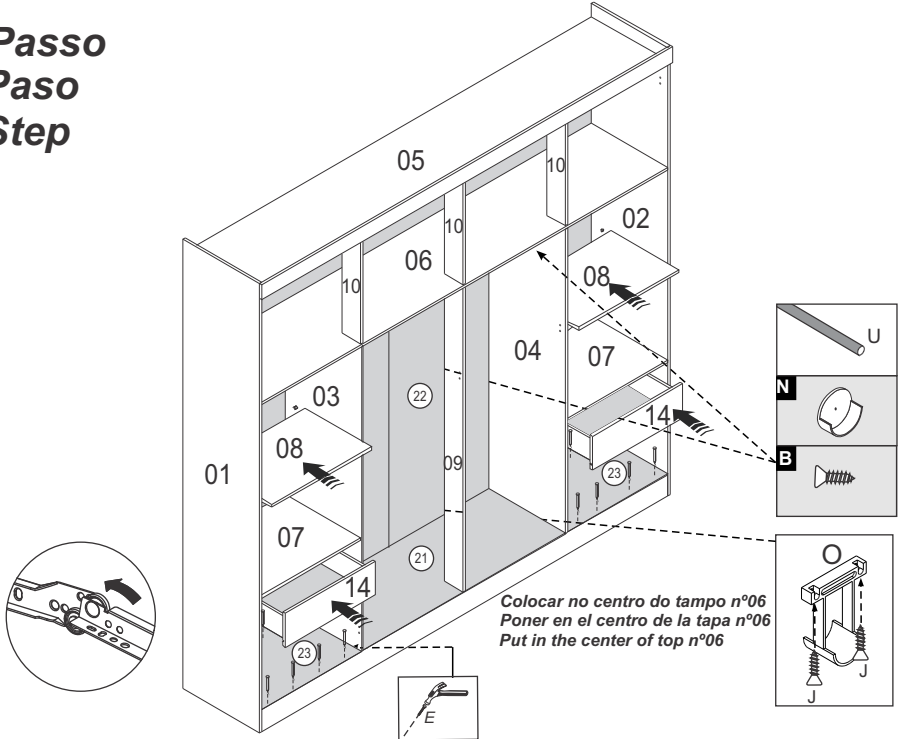

**Colocar no centro do tampo nº06**  
**Poner en el centro de la tapa nº06**  
**Put in the center of top nº06**

**11º Passo**  
**11º Paso**  
**11º Step**

Montagem das dobradiças nas portas (17,18) colocando calço e dobradiça.  
Montaje de las bisagras en las puertas (17,18) Poner la base y bisagra.  
The assembly of the Hinge in the door (17,18) putting the base of Hinge and hinge.

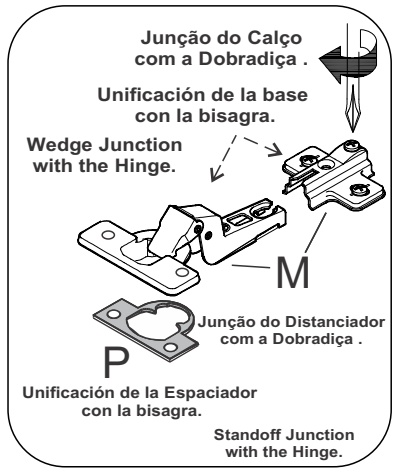
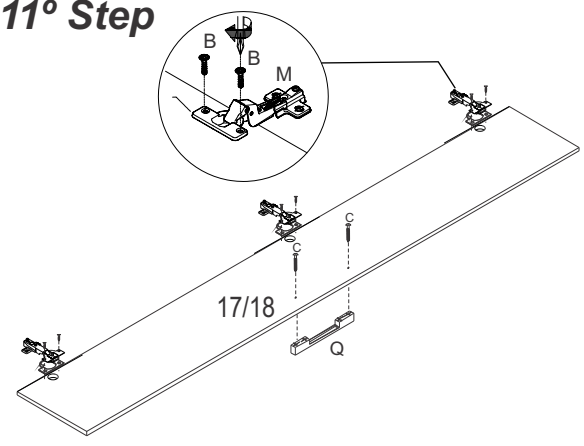

**12º Passo**  
**12º Paso**  
**12º Step**

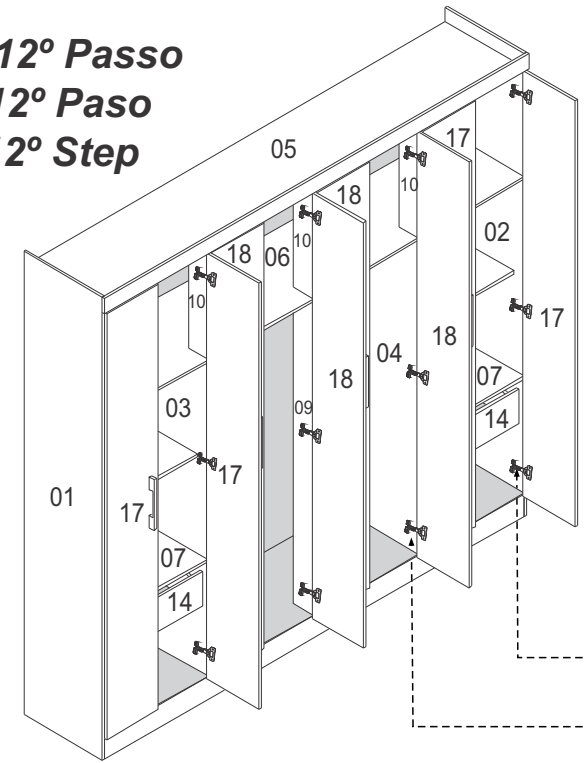

**EM TODAS AS PORTAS DA MESMA MANEIRA**  
**EN TODAS LAS PUERTAS DE LA MISMA MANERA**  
**ON ALL DOORS THE SAME WAY**

**REGULAGEM / REGLAJE / ADJUSTMENT**

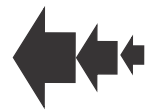

**Possuem marcação de fixação das dobradiças nas peças. (01,02,03,04,09).**  
**Tienen perforación de fijación de las bisagras en las piezas (01,02,03,04,09).**  
**There are markings of hinges assembly in the parts (01,02,03,04,09).**

