

# Multiuso / Multiuse HAVANA NEW BC-9500

## MANUAL DE MONTAGEM INSTRUCCIONES DE ARMADO ASSEMBLY INSTRUCTIONS

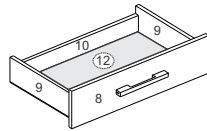

### Ferramentas necessárias (não fornecidas)

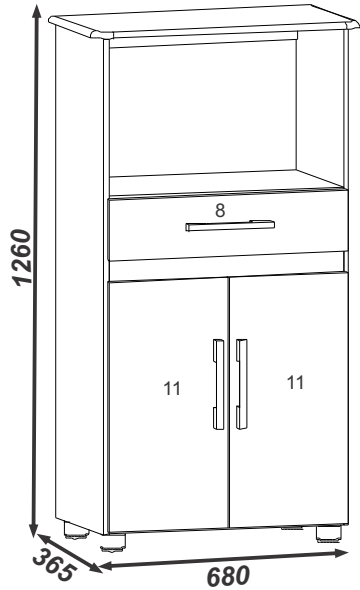
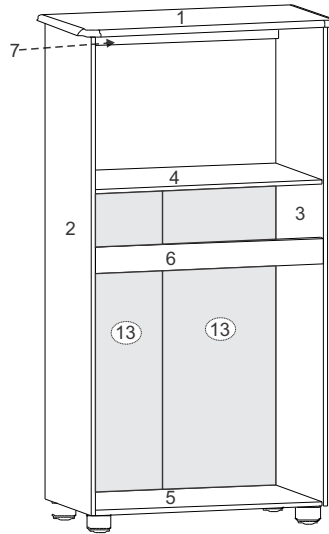
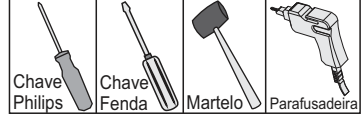

- 1-Tampo superior
- 2-Lateral esquerda
- 3-Lateral direita
- 4-Tampo central
- 5-Tampo inferior
- 6-Travessa central
- 7-Travessa superior
- 8-Frente de gaveta
- 9-Lateral de gaveta (2x)
- 10-Traseiro de gaveta
- 11-Portas (2x)
- 12-Fundo de gaveta
- 13-Costas (2x)

- 1-Tapa superior
- 2-Lateral izquierda
- 3-Lateral derecha
- 4-Tapa central
- 5-Tapa inferior
- 6-Travessa central
- 7-Travesaño superior
- 8-Frente del cajón
- 9-Lateral del cajón (2x)
- 10-Trasero del cajón
- 11-Puertas (2x)
- 12-Fondo del cajón
- 13-Dorso (2x)

- 1-Upper Top
- 2-Left Side
- 3-Right Side
- 4-Central Top
- 5-Lower Top
- 6-Central Crossbar
- 7-Upper Crossbar
- 8-Drawer Front
- 9-Drawer Side (2x)
- 10-Drawer Back
- 11-Door (2x)
- 12-Drawer Bottom
- 13-Back Panel (2x)

### Ferragens/Herraje/Hardware:

|       |   |   |  |    |
|-------|---|---|--|----|
| 330   | A | Cavilhas 6 x 30<br>Wood Peg   |  | 20 |
| 0283  | B | Parafuso 3,5 x 12 c/c<br>Tornillo<br>Screw  |  | 36 |
| 0289  | C | Parafuso 3,5 x 40 CC<br>Tornillo<br>Screw   |  | 12 |
| 6706  | D | Pé bola<br>Pata<br>Feet   |  | 04 |
| 0285  | G | Parafuso 3,5 x 25 c/f<br>Tornillo<br>Screw  |  | 06 |
| 0296  | H | Taxa 10 x 7<br>Clavo 10 x 7<br>Nail 10 x 7  |  | 50 |
| 0477  | I | Cola<br>Pegamento<br>Glue   |  | 01 |
| 0438  | J | Cantoneira<br>Esquinera<br>Cantoneira   |  | 06 |
| 298   | K | Pino de Pé PRETO<br>Passador de patas negro<br>Black Foot Bolt  |  | 04 |
| 151   | L | Dobradilha metal 26 mm<br>Bisagra<br>Hinge  |  | 04 |
| ----- | M | Perfil H 794 mm<br>Perfil H 794 mm<br>Profile H 794 mm  |  | 01 |
| 0744  | N | Taxa 13 x 15<br>Clavo 13 x 15<br>Nail 13 x 15   |  | 04 |
| 3049  | O | Corredilha metálica Slim<br>Rieles<br>Slides  |  | 01 |
| ----- | P | Puxador 192 Gecele<br>Tirador<br>Handle   |  | 03 |
| 0115  | Q | Parafuso minifix<br>Tornillo<br>Minifix screw   |  | 04 |
| 0973  | R | Tambor minifix 12 mm<br>Minifix 12 mm<br>Minifix 12 mm  |  | 04 |
| ----- | S | Tapa Furo Adesivo 18mm COR 1<br>Pegatina Para Agujeros 18mm COLOR 1<br>Slap hole adesivo 18mm color 1 |  | 04 |

- 1-680 X 370 X 15
- 2-1200 X 355 X 12
- 3-1200 X 355 X 12
- 4-598 X 354 X 12
- 5-598 X 354 X 12
- 6-598 X 65 X 15
- 7-598 X 65 X 15
- 8-606 X 147 X 15
- 9-338 X 95 X 15
- 10-544 X 65 X 15
- 11-606 X 302 X 15
- 12-572 X 341 X 3
- 13-805 X 305 X 3

DIMENSÕES PEÇAS PRONTAS  
DIMENSIONES DE LAS PEZAS PRONTAS  
DIMENSIONS READY MADE PARTS

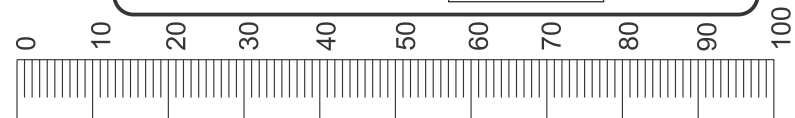
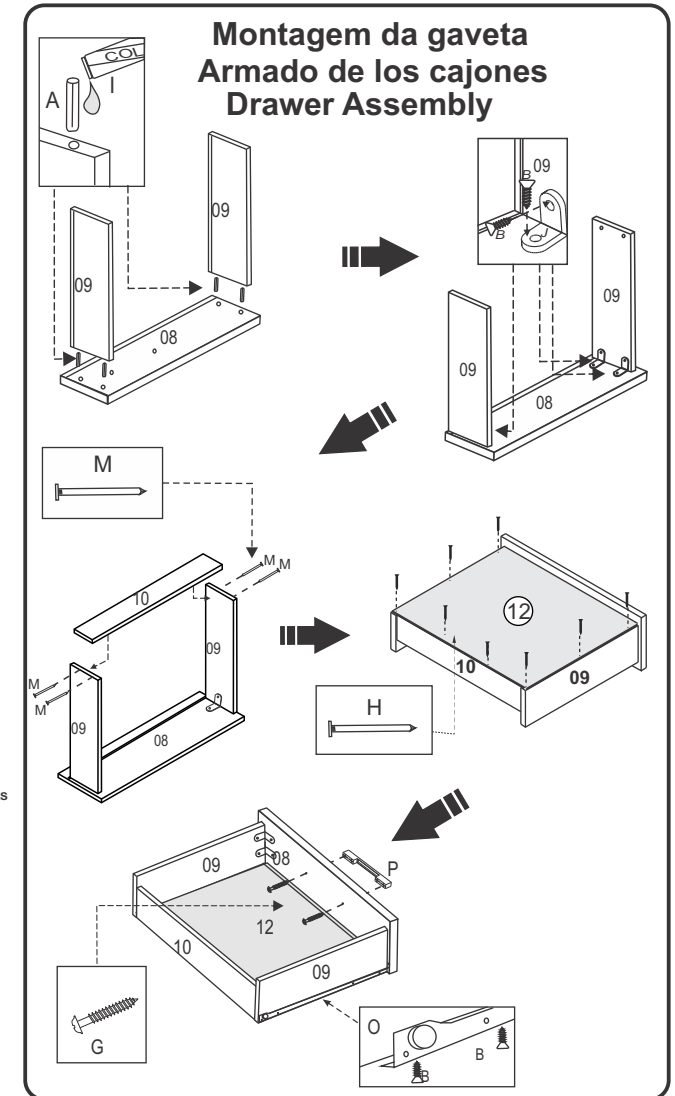

### Instruções para a montagem do produto:

**Separe as peças e acessórios de maneira organizada.**  
Separate the parts and accessories in an organized way.  
Separe las piezas y accesorios de forma organizada

**Forrar o chão com o papelão das embalagens.**  
Cover the floor with the cardboard from the pack.  
Cubre el suelo con el cartón de los bultos.



**É necessário duas pessoas para montar o produto.**  
It's necessary two people to assembly the product.  
Se requiere dos personas para montar el producto.

**1º Passo**  
**1º Paso**  
**1º Step**

*Atenção! ao parafusar a corredeira  
 ,cuidar o lado certo.*

*Atención! al atornillar la corredera,  
 cuidar para que esté en el lado correcto*

*Attention!When screwing the slide,  
 take care to do the right side*

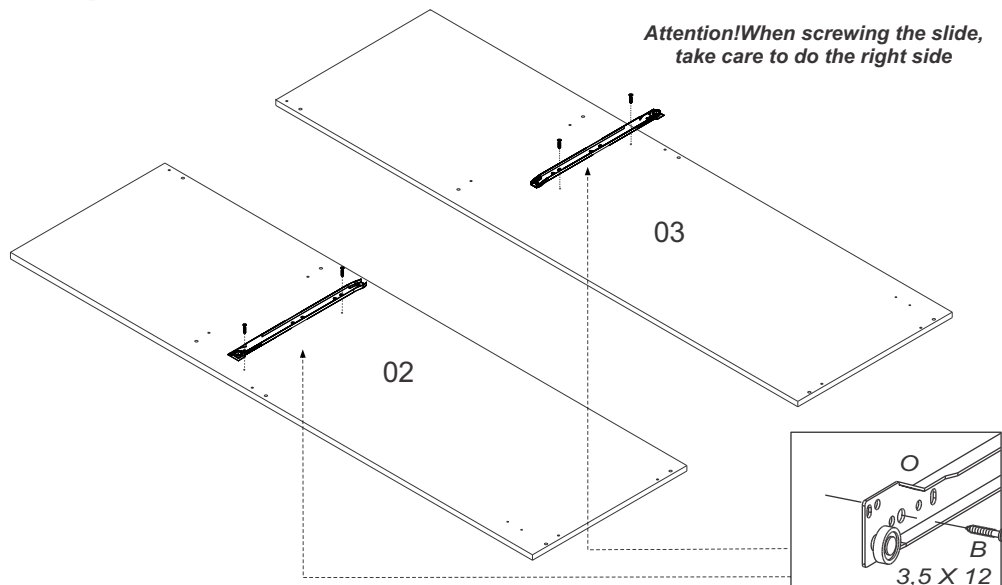

**2º Passo**  
**2º Paso**  
**2º Step**

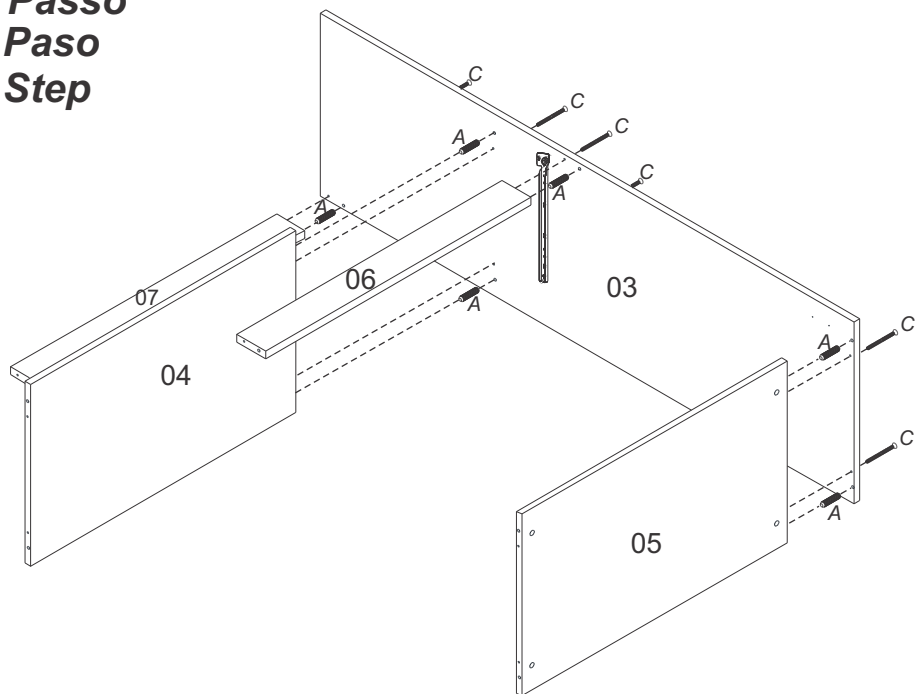

**3º Passo**  
**3º Paso**  
**3º Step**

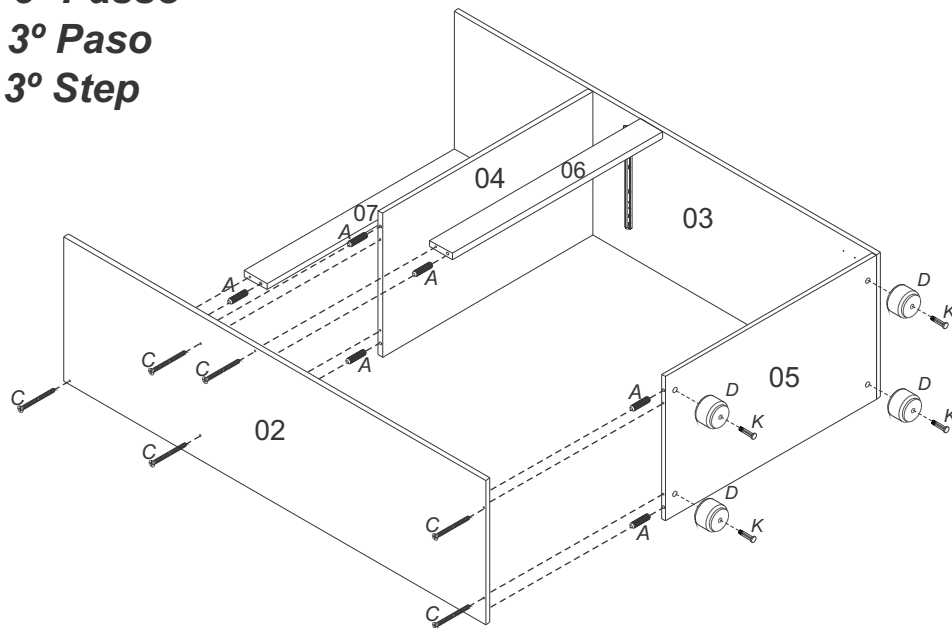

**4º Passo**  
**4º Paso**  
**4º Step**

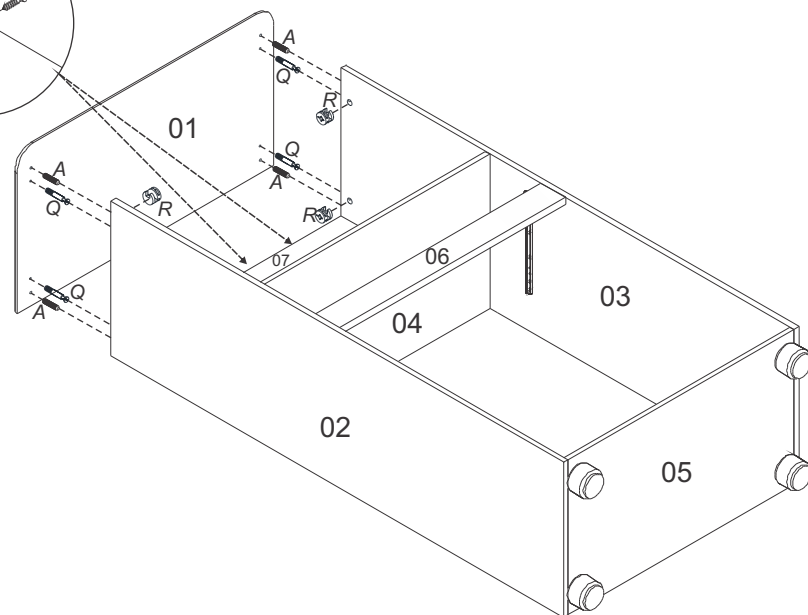
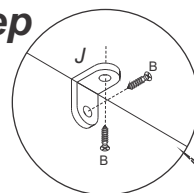

### 5º Passo

### 5º Paso

### 5º Step

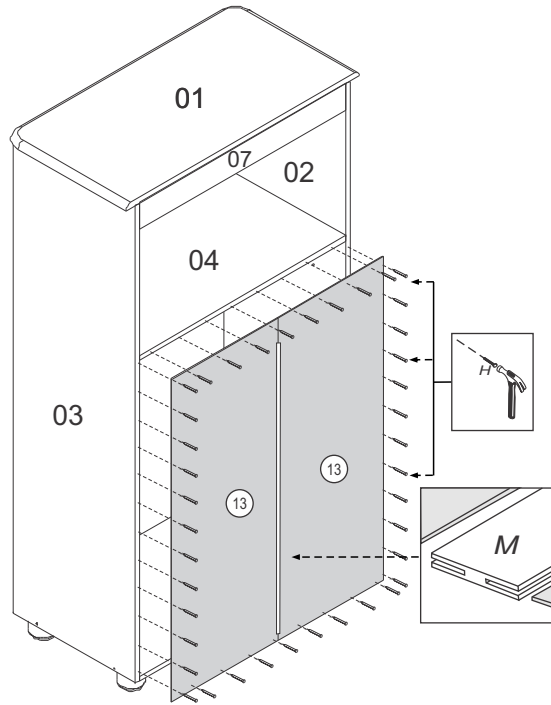

### 6º Passo

### 6º Paso

### 6º Step

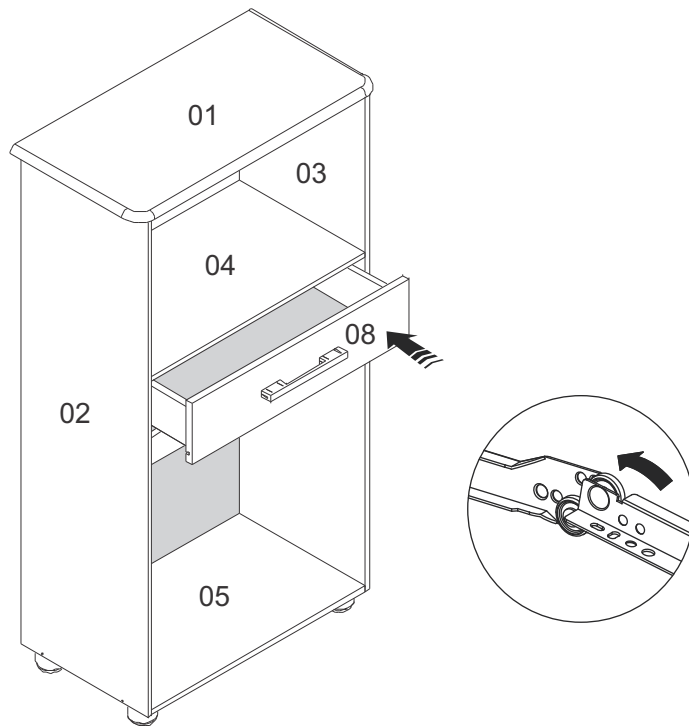

### 7º Passo

### 7º Paso

### 7º Step

Montagem das dobradiças nas portas (11) colocando calço e dobradiça.

Montaje de las bisagras en las puertas (11) Poner la base y bisagra.

The assembly of the Hinge in the door (11) putting the base of Hinge and hinge .

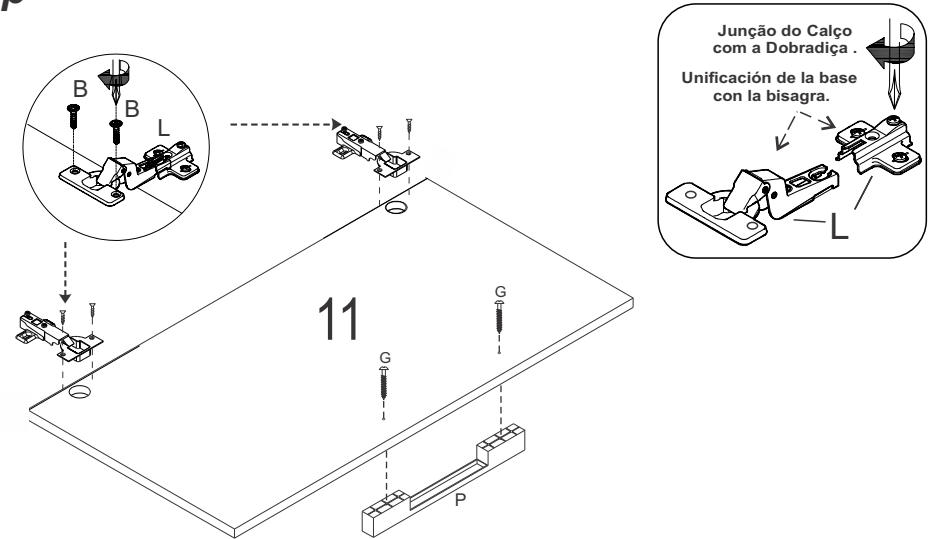

### 8º Passo

### 8º Paso

### 8º Step

EM TODAS AS PORTAS DA MESMA MANEIRA  
EN TODAS LAS PUERTAS DE LA MISMA MANERA  
ON ALL DOORS THE SAME WAY

REGULAGEM / REGLAJE / ADJUSTMENT

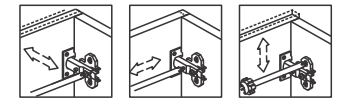

Possuem marcação de fixação das dobradiças nas peças. (02,03).

Tienen perforación de fijación de las bisagras en las piezas (02,03).

There are markings of hinges assembly in the parts (02,03).

