

# Fruteira/Fruit Bowl/Tazón de frutas

## GRAMADO

BC-0832

Lote: 000000

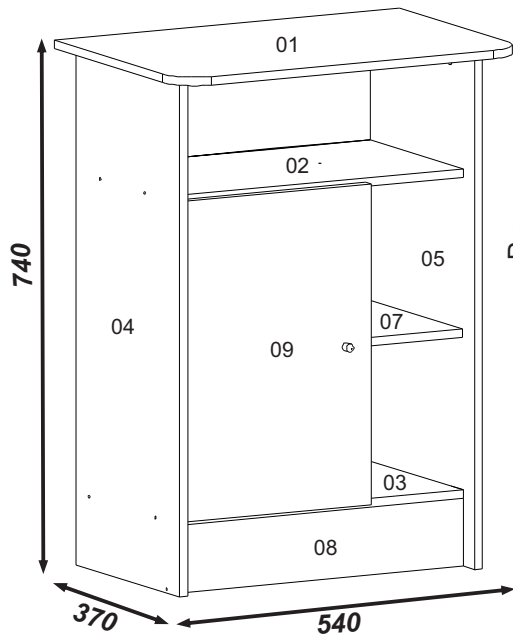

Por

01-Tampo superior  
02-Tampo central  
03-Tampo inferior  
04-Lateral esquerda  
05-Lateral direita  
06-Lateral interna  
07-Prateleira  
08-Rodapé  
09-Porta  
10-Costa porta  
11-Costa direita

Esp

01-Tapa superior  
02-Tapa central  
03-Tapa inferior  
04-Lateral izquierda  
05-Lateral derecha  
06-Lateral interna  
07-Estante  
08-Zócalo  
09-Puerta  
10-Dorso puerta  
11-Dorso derecho

Eng

01-Upper top  
02-Center top  
03-Lower top  
04-Left side  
05-Right side  
06-Internal side  
07-Shelf  
08-Base board  
09-Door  
10-Door back panel  
11-Right back panel

DIMENSÕES PEÇAS PRONTAS  
DIMENSIONES DE LAS PEZAS PRONTAS  
DIMENSIONS READY MODE PARTS

01- 544 x 360 x 12 MM  
02- 452 X 269 X 12 MM  
03- 452 X 269 X 12 MM  
04- 726 X 300 X 12 MM  
05- 726 X 300 X 12 MM  
06- 438 X 267 X 12 MM  
07- 147 X 265 X 12 MM  
08- 452 X 95 X 12 MM  
09- 450 X 297 X 15 MM  
10- 458 X 308 X 3 MM  
11- 458 X 162 X 3 MM

### Ferragens/Herraje/Hardware:

330	A	Cavilhas 6 x 30 Clavija Wood Peg		22
0289	B	Parafuso 3,5 x 40 CC Tornillo Screw		14
0916	C	<b>Puxador</b> Tirador Handle		01
0285	D	<b>Parafuso 3,5 x 25 c/f</b> Tornillo Screw		01
0477	F	Cola Pegamento Glue		01
3143	H	<b>Dobradiça metal Calço 12</b> Bisagra Hinge		02
0296	H	Taxa 10 x 7 Clavo 10 x 7 Nail 10 x 7		25
0283	J	Parafuso 3,5 x 12 CC Tornillo Screw		08
0115	L	Parafuso minifix Tornillo Screw		04
0973	M	Tambor minifix 12 mm Minifix 12 mm Minifix 12 mm		04
-----	N	Sapata U 15 x 15 Pata U 15 x 15 Feet U 15 x 15		04
-----	O	Tapa Furo Adesivo 18mm Pegatina Para Agujeros 18mm Slap hole adesivo 18mm		04
0279	R	Fixador De Costa Fixador de Espalda Fix Back		04

### Instruções para a montagem do produto:

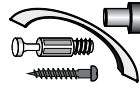

**Separe as peças e acessórios de maneira organizada.**

Separate the parts and accessories in an organized way.

Separate las piezas y accesorios de forma organizada

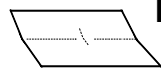

**Forrar o chão com o papelão das embalagens.**

Cover the floor with the cardboard from the pack.

Cubre el suelo con el cartón de los bultos.



**É necessário duas pessoas para montar o produto.**

It's necessary two people to assembly the product.

Se requiere dos personas para montar el producto.

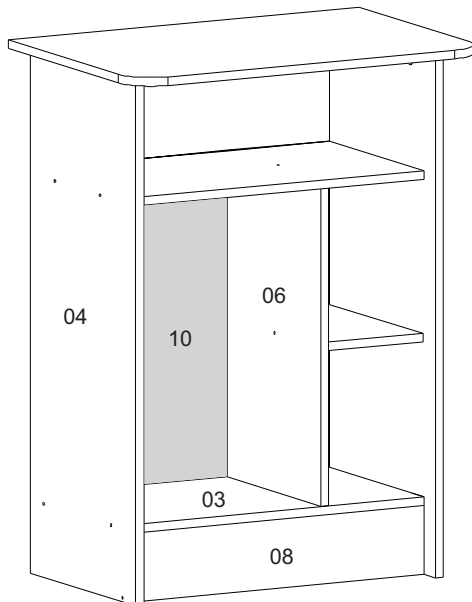

medidas em mm  
measure in mm

### Ferramentas necessárias (não fornecidas)

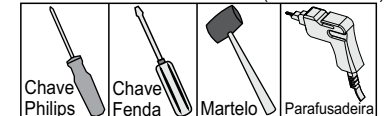

MANUAL DE MONTAGEM  
INSTRUCCIONES DE ARMADO  
ASSEMBLY INSTRUCTIONS

**01° Passo**  
**01° Paso**  
**01° Step**

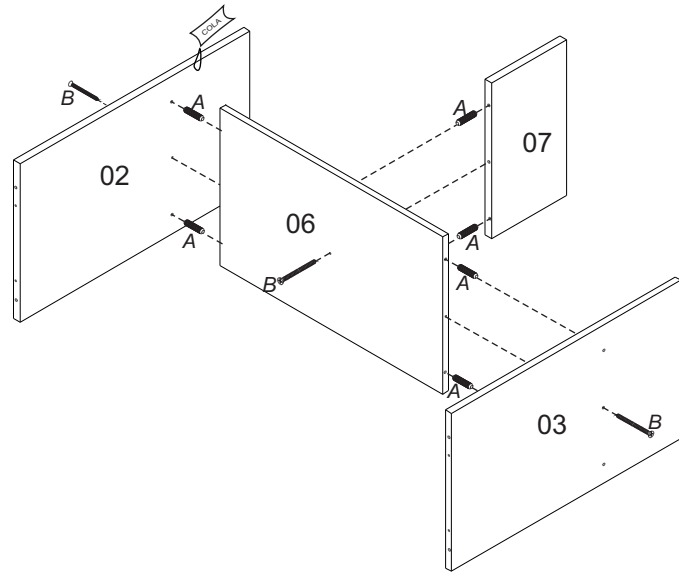

**02° Passo**  
**02° Paso**  
**02° Step**

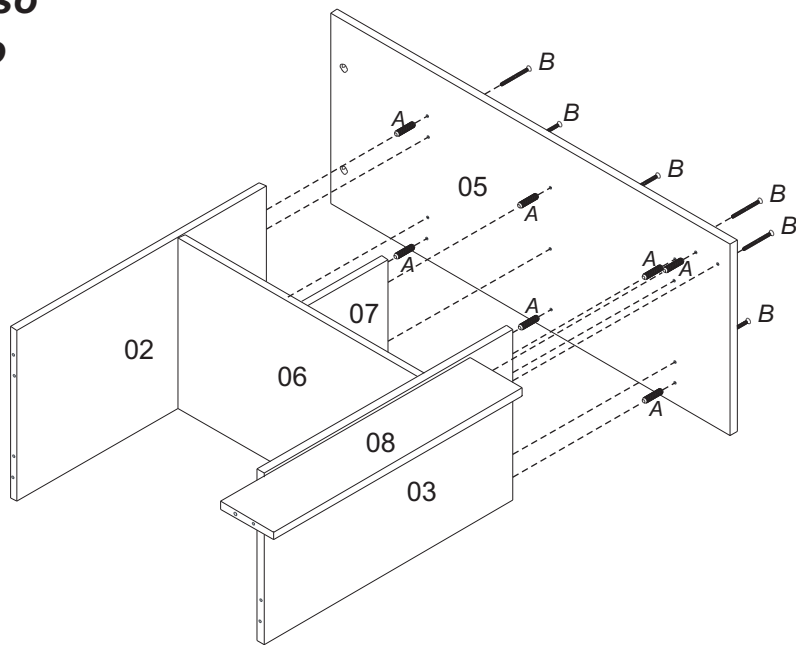

**03° Passo**  
**03° Paso**  
**03° Step**

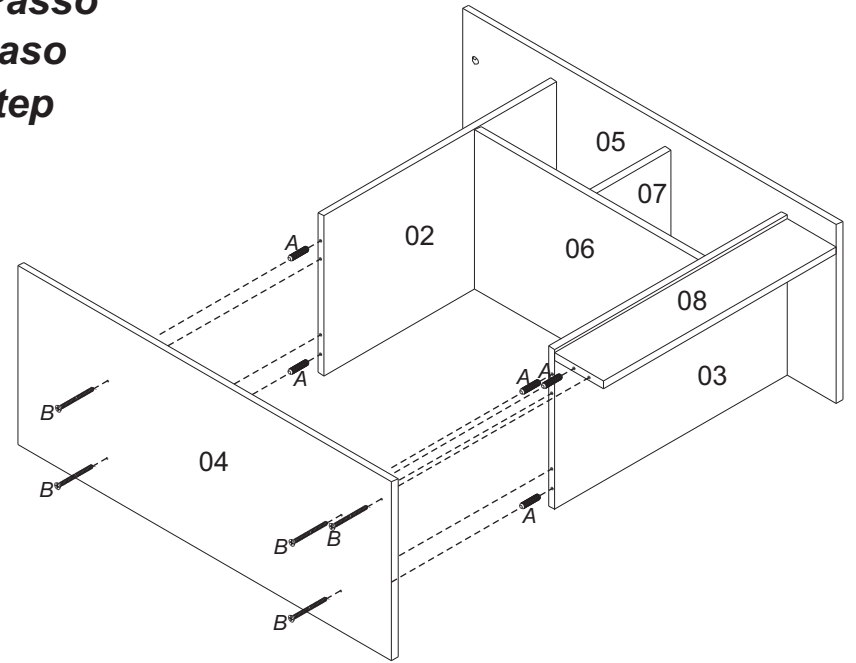

**04° Passo**  
**04° Paso**  
**04° Step**

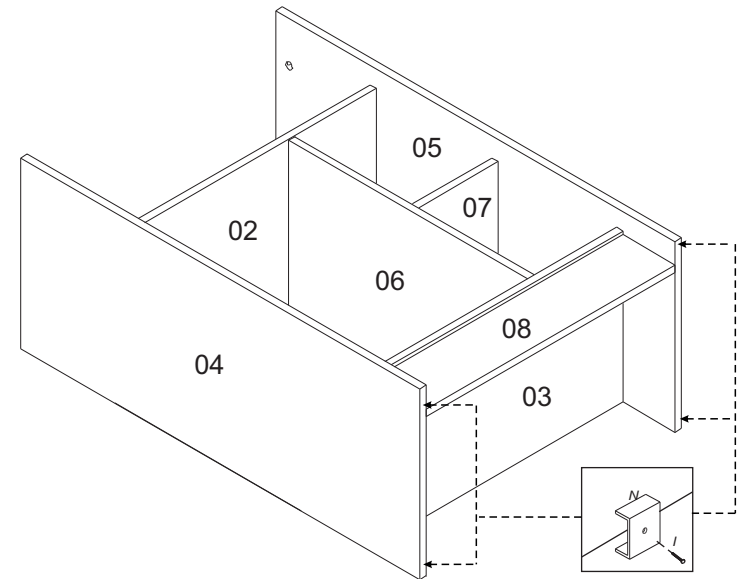

### 05° Passo

### 05° Paso

### 05° Step

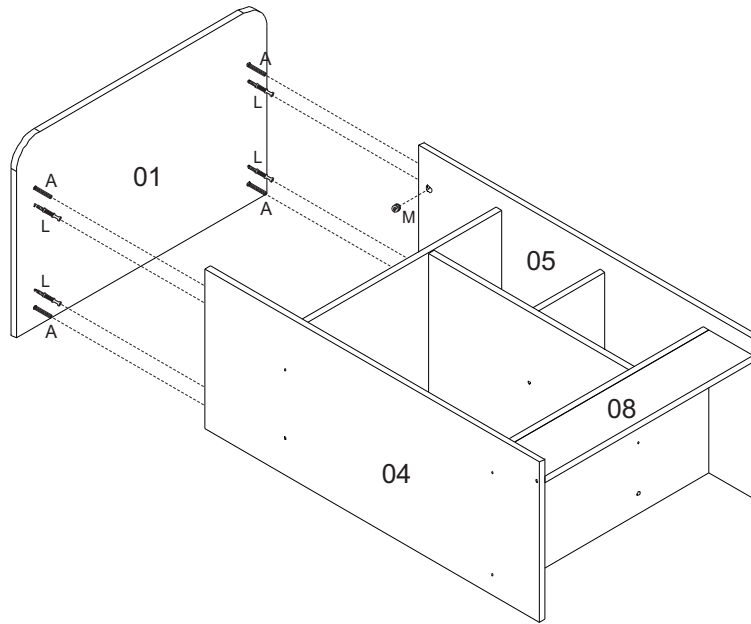

### 06° Passo

### 06° Paso

### 06° Step

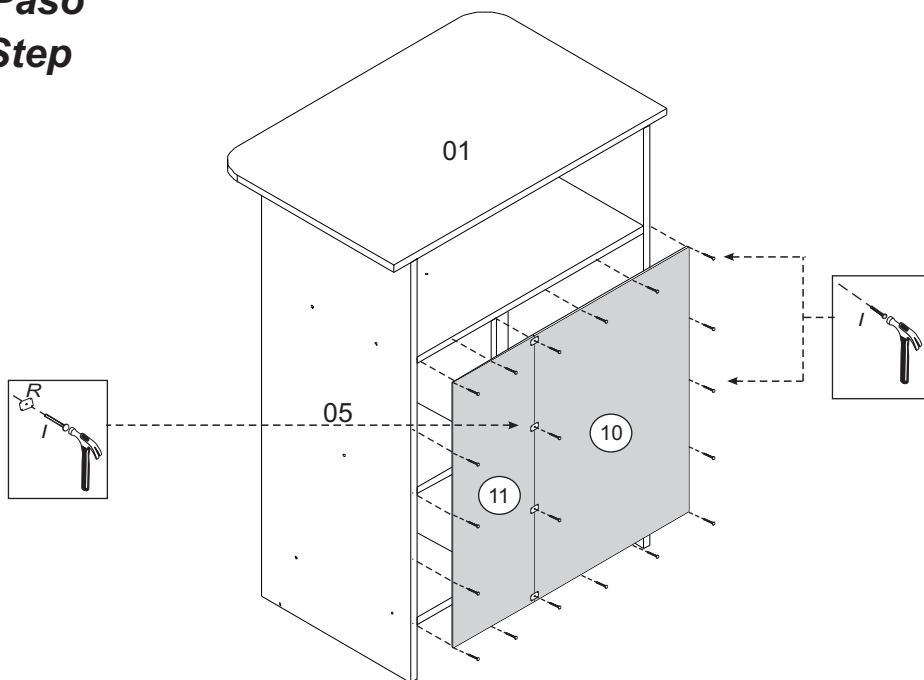

### 07° Passo

### 07° Paso

### 07° Step

Montagem das dobradiças nas portas (09) colocando calço e dobradiça.

Montaje de las bisagras en las puertas (09) Poner la base y bisagra.

The assembly of the Hinge in the door (09) putting the base of Hinge and hinge .

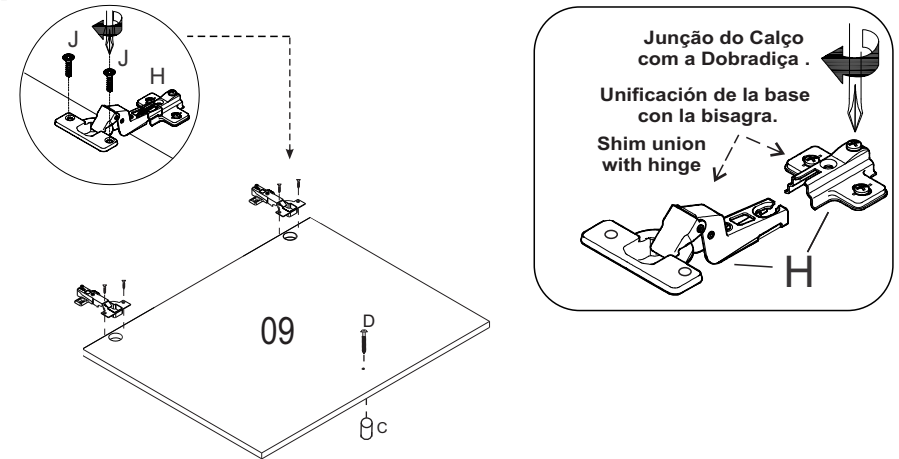

### 08° Passo

### 08° Paso

### 08° Step

REGULAGEM / REGLAJE / ADJUSTMENT

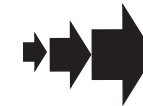
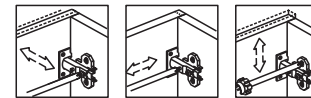

Possuem marcação de fixação das dobradiças na peça. (04).

Tienen perforación de fijación de las bisagras en la pieza (04).

There are markings of hinges assembly in the part (04).

