

# Multiuso/Multifunctional SEUL BC-5275

MANUAL DE MONTAGEM  
INSTRUCCIONES DE ARMADO  
ASSEMBLY INSTRUCTIONS

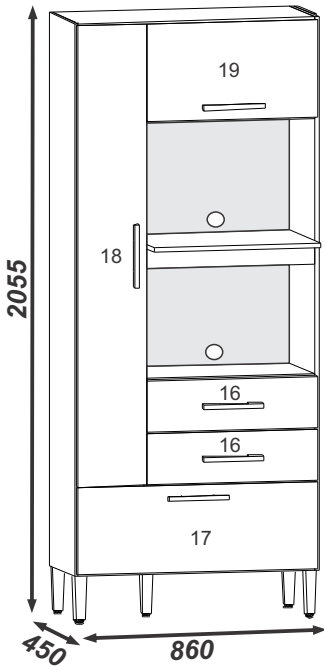

- P.O.**
- 01-LATERAL ESQUERDA
  - 02-LATERAL DIREITA
  - 03-DIVISÓRIA
  - 04-TAMPO SUPERIOR
  - 05-TAMPO INFERIOR
  - 06-TAMPO INFERIOR ESQUERDO
  - 07-PRATELEIRA ESQUERDA (2x)
  - 08-LATERAL DE GAVETA (2x)
  - 09-TRASEIRO DE GAVETA
  - 10-TAMPO SUPERIOR DIREITO (2x)
  - 12-TRAVESSA TAMPO FORNO
  - 14-TAMPO MICRO
  - 15-TAMPO FORNO
  - 16-FRENTE DE GAVETA
  - 17-PORTA INFERIOR
  - 18-PORTA ESQUERDA
  - 19-PORTA SUPERIOR
  - 20-COSTA ESQUERDA
  - 21-COSTA INFERIOR (2x)
  - 22-COSTA MICRO
  - 23-COSTA FORNO
  - 25-COSTA SUPERIOR
  - 26-FUNDO DE GAVETA

- L.O.**
- 01-LATERAL IZQUIERDA
  - 02-LATERAL DERECHA
  - 03-DIVISION
  - 04-TAPA SUPERIOR
  - 05-TAPA INFERIOR
  - 06-TAPA INFERIOR IZQUIERDO
  - 07-ESTANTE IZQUIERDA (2x)
  - 08-LATERAL DEL CAJÓN (2x)
  - 09-TRASERO DEL CAJÓN
  - 10-TAPA SUPERIOR DERECHO (2x)
  - 12-TRAVESAÑO TAPA HORNO
  - 14-TAPA MICRO
  - 15-TAPA HORNO
  - 16-FRENTE DEL CAJÓN
  - 17-PUERTA INFERIOR
  - 18-PUERTA IZQUIERDA
  - 19-PUERTA SUPERIOR
  - 20-DORSO IZQUIERDA
  - 21-DORSO INFERIOR (2x)
  - 22-DORSO MICRO
  - 23-DORSO HORNO
  - 25-DORSO SUPERIOR
  - 26-FONDO DEL CAJÓN

- L.O.**
- 01-LEFT SIDE
  - 02-RIGHT SIDE
  - 03-DIVIDER
  - 04-UPPER TOP
  - 05-LOWER TOP
  - 06-LEFT LOWER TOP
  - 07-LEFT SHELF (2x)
  - 08-DRAWER SIDE (2x)
  - 09-DRAWER BACK
  - 10-RIGHT UPPER TOP (2x)
  - 12-OVEN TOP CROSSBAR
  - 14-MICRO TOP
  - 15-OVEN TOP
  - 16-DRAWER FRONT
  - 17-LOWER DOOR
  - 18-LEFT DOOR
  - 19-UPPER DOOR
  - 20-LEFT BACK PANEL
  - 21-LOWER BACK PANEL (2x)
  - 22-MICRO BACK PANEL
  - 23-OVEN BACK PANEL
  - 25-UPPER BACK PANEL
  - 26-DRAWER BOOTOM

DIMENSÕES PEÇAS PRONTAS  
DIMENSIONES DE LAS PEZAS PRONTAS  
DIMENSIONS READY MODE PARTS

- 01-1895 X 360 X 12
- 02-1895 X 360 X 15
- 03-1871 X 359 X 12
- 04-834 X 359 X 12
- 05-834 X 359 X 12
- 06-233 X 359 X 12
- 07-233 X 299 X 12
- 08-338 X 95 X 12
- 09-541 X 65 X 12
- 10-589 X 359 X 12
- 12-589 X 65 X 15
- 14-589 X 359 X 15
- 15-589 X 450 X 15
- 16-597 X 177 X 15
- 17-842 X 297 X 15
- 18-1578 X 241 X 15
- 19-597 X 332 X 15
- 20-1892 X 247 X 3
- 21-605 X 333 X 3
- 22-605 X 455 X 3
- 23-605 X 431 X 3
- 25-605 X 341 X 3
- 26-563 X 341 X 3

## Ferragens/Herraje/Hardware:

330	A	Cavilhas 6 x 30 Wood Peg		46
0289	B	Parafuso 3,5 x 40 Tornillo Screw		34
-----	C	Puxador 192 mm CROMADO Tirador Handle		05
0285	D	Parafuso 3,5 x 25 flangeado Tornillo Screw		12
0477	E	Cola Pegamento Glue		01
0283	G	Parafuso 3,5 x 12 c/c Tornillo Screw		76
0296	H	Taxa 10 x 7 Clavo 10 x 7 Nail 10 x 7		80
151	I	Dobradiça metal Bisagra Hinge		08
0538	J	Porca cilíndrica Tuerca cilíndrica Cylindrical nut		10
0438	K	Cantoneira Esquinera Cantoneira		10
-----	L	Pés Pies Feet		05
0555	M	Parafuso 5 X 50 Tornillo Screw		05
0279	N	Fixador De Costa Fixador de Espalda Fix Back		21
1549	P	Articulador Articulador Articulator		01
3049	Q	Corrediça metálica slim 350mm Rieles Slides		02
4738	R	Cantoneira Plástica Refuerzo de plástico Plastic gusset		02
0286	S	Parafuso 3,5 x 22 c/c Tornillo Screw		02
0744	T	Taxa 13 x 15 Clavo 13 x 15 Nail 13 x 15		08
-----	U	Perfil 588 mm Perfil Profile		01

### Instruções para a montagem do produto:

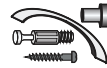

**Separe as peças e acessórios de maneira organizada.**

Separate the parts and accessories in an organized way.

Separate las piezas y accesorios de forma organizada

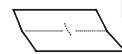

**Forrar o chão com o papelão das embalagens.**

Cover the floor with the cardboard from the pack.

Cubre el suelo con el cartón de los bultos.



**É necessário duas pessoas para montar o produto.**

It's necessary two people to assembly the product.

Se requiere dos personas para montar el producto.

**Ferramentas necessárias**(não fornecidas)

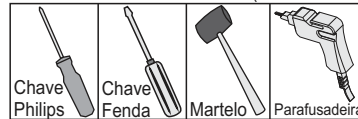

Chave  
Philips

Chave  
Fenda

Martelo

Parafusadeira



medidas em mm

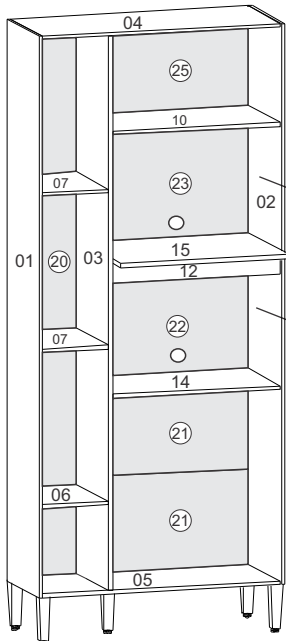

ESPAÇO LIVRE  
589 X 420

ESPAÇO LIVRE  
589 X 375

Parafuso 3,5 x 25 c/c opcional para juntar os modulo.  
Tornillo 3,5 x 25 c/c opcional para unificar los modulos.  
Optional 3,5 x 25 c/c for joining modules.

**Montagem da gaveta**  
**Armado de los cajones**  
**Drawer Assembly**

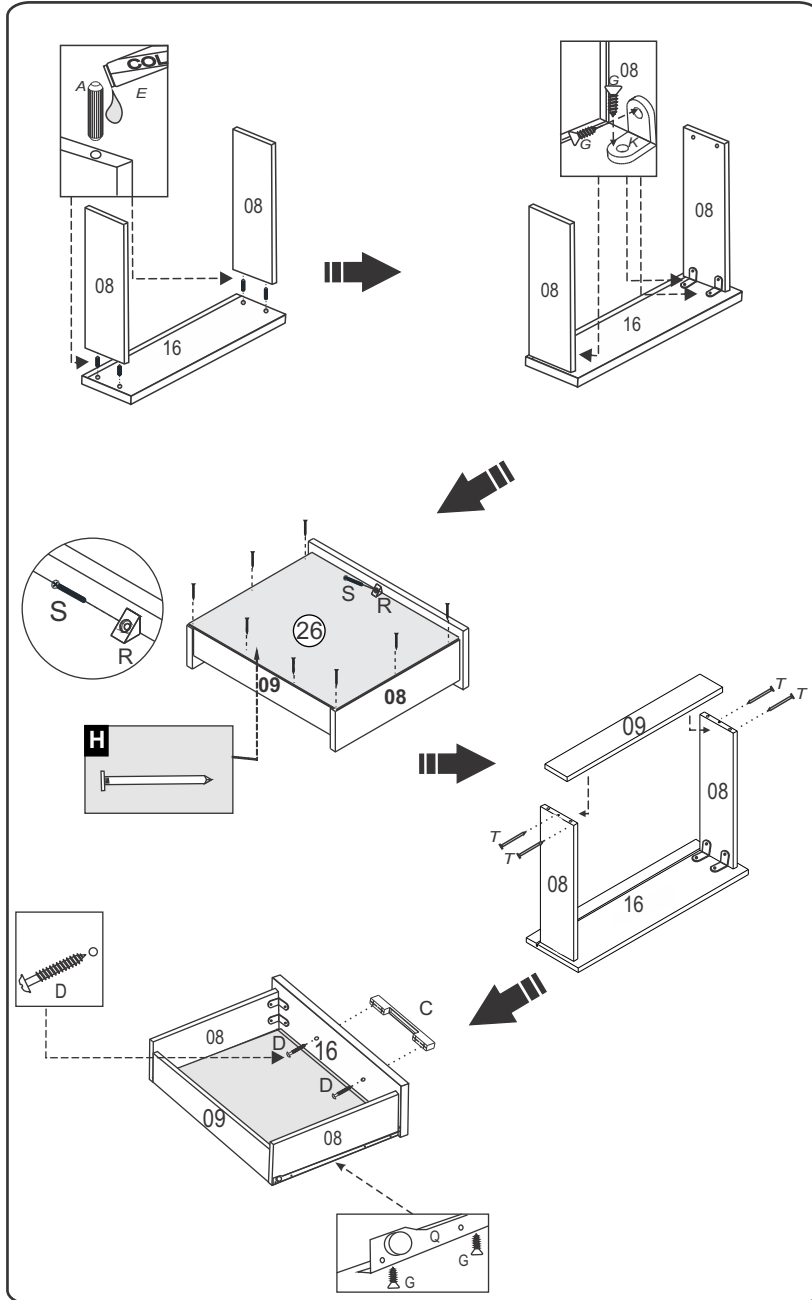

**1º Passo**  
**1º Paso**  
**1º Step**

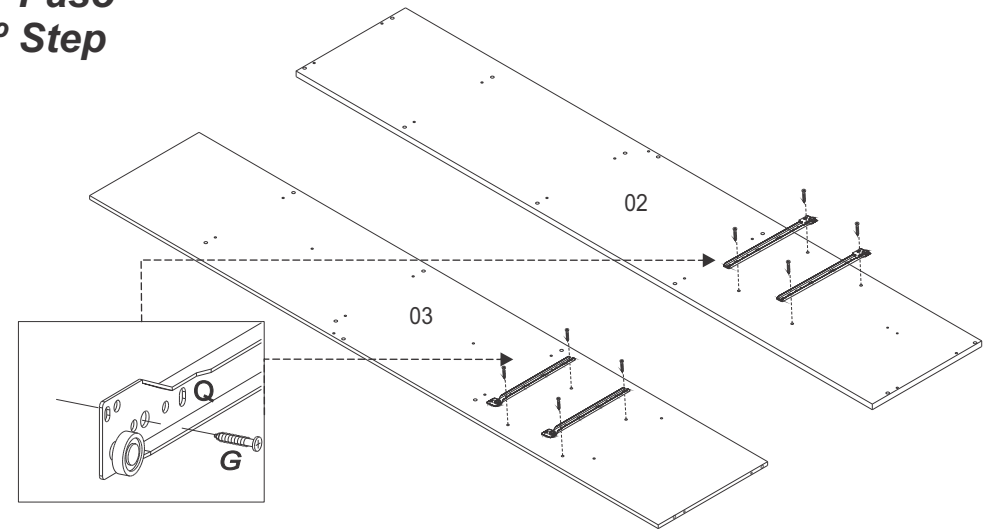

**Atenção! ao parafusar a correção** **Atención! al atornillar la corredera,** **Attention! When screwing the slide,**  
**,cuidar o lado certo.** **cuidar para que esté en el lado correcto** **take care to do the right side**

**2º Passo**  
**2º Paso**  
**2º Step**

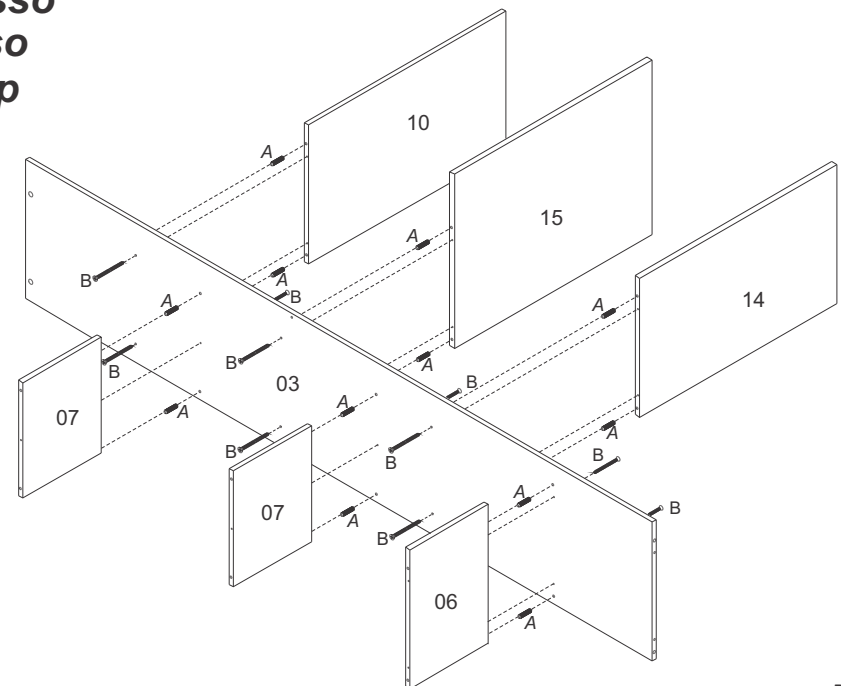

**3° Passo**

**3° Paso**

**3° Step**

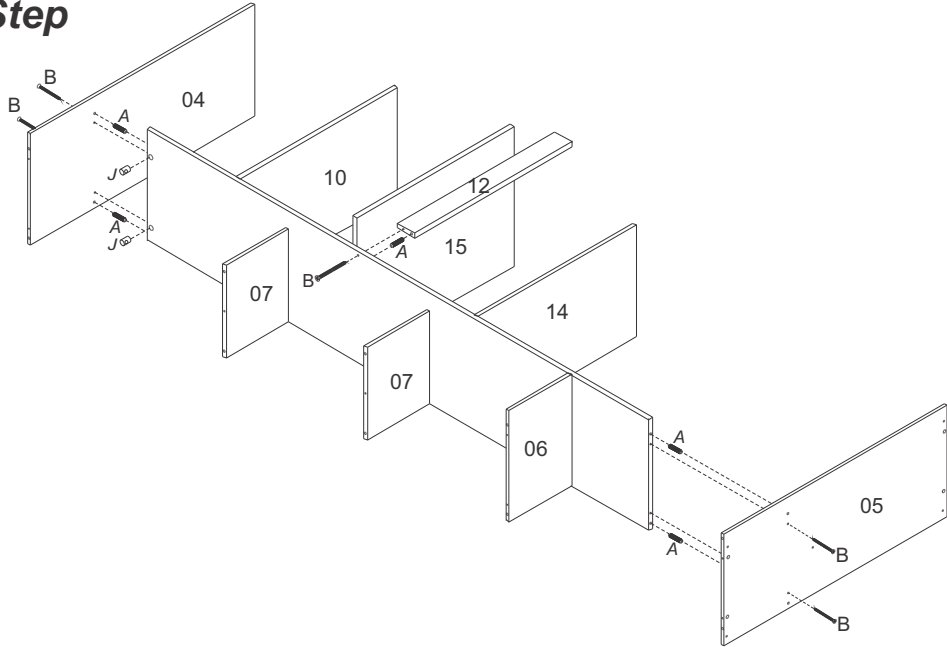

**4° Passo**

**4° Paso**

**4° Step**

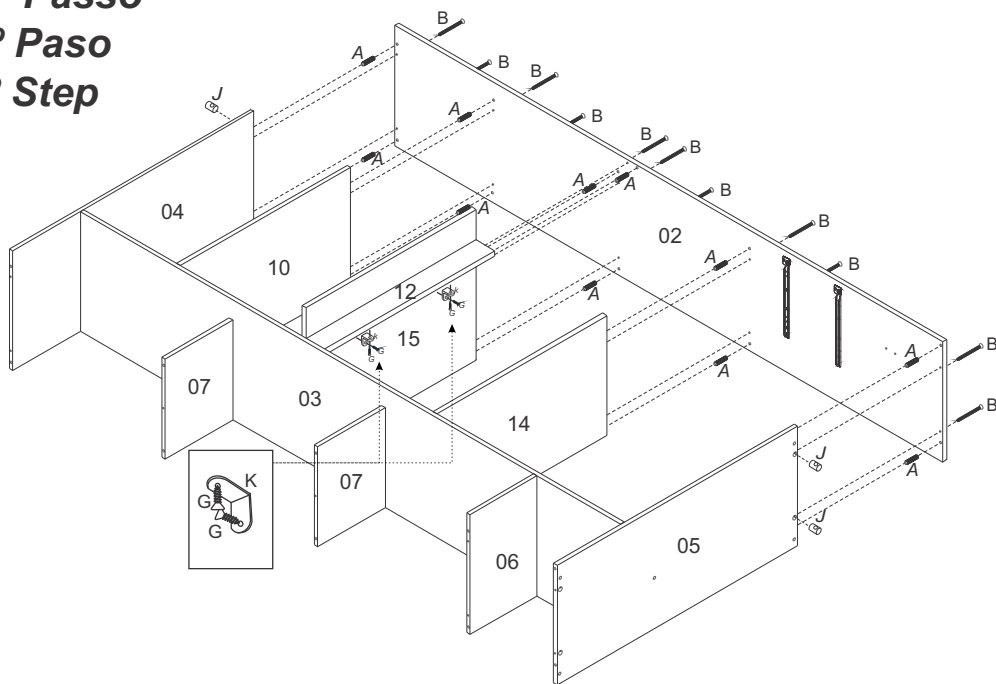

**5° Passo**

**5° Paso**

**5° Step**

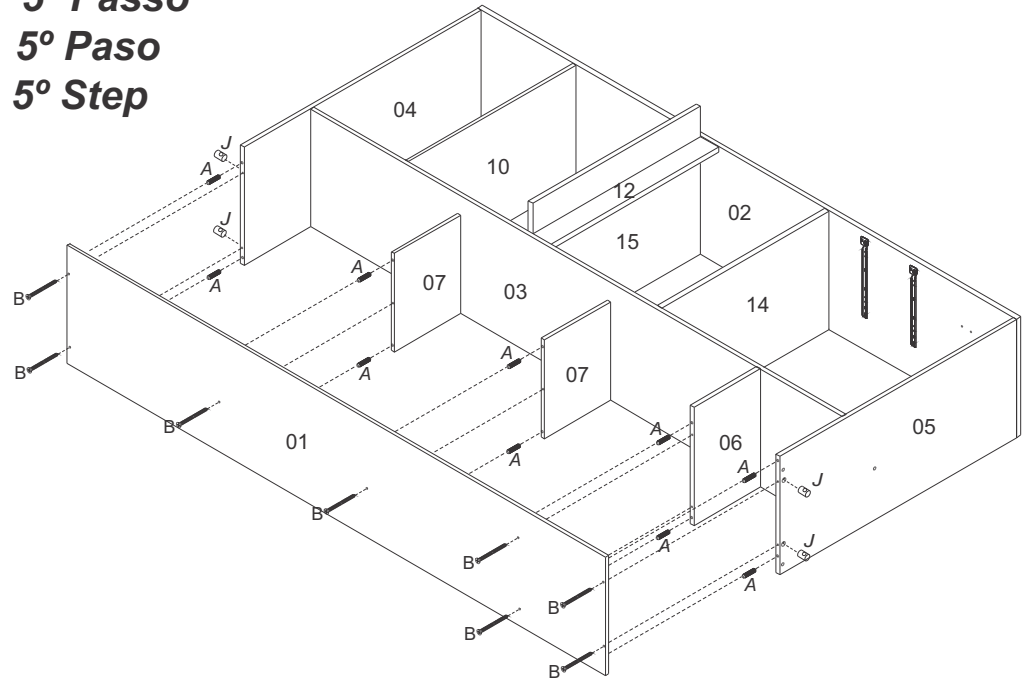

**6° Passo**

**6° Paso**

**6° Step**

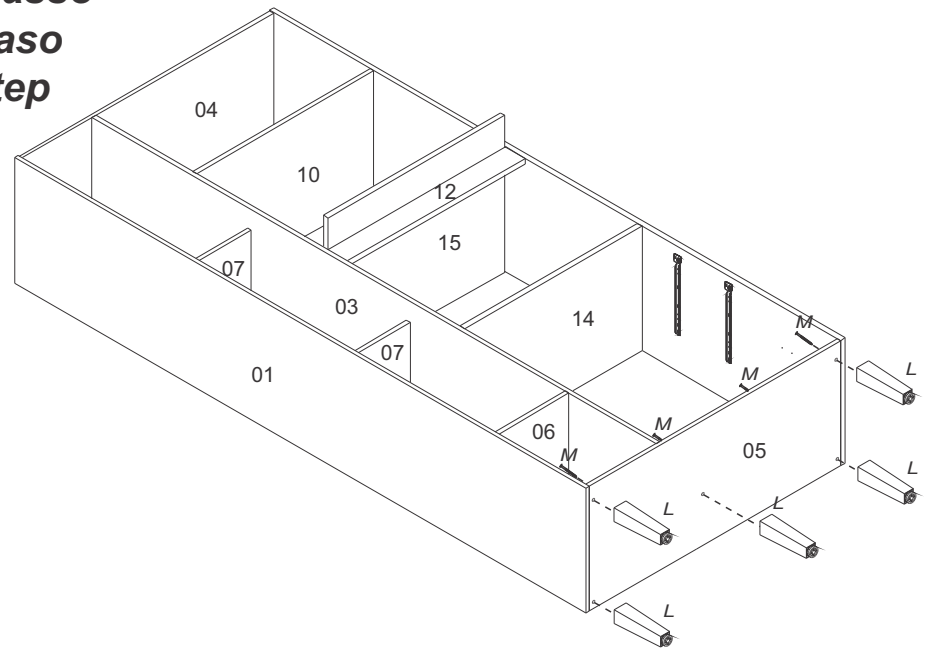

**7º Passo**  
**7º Paso**  
**7º Step**

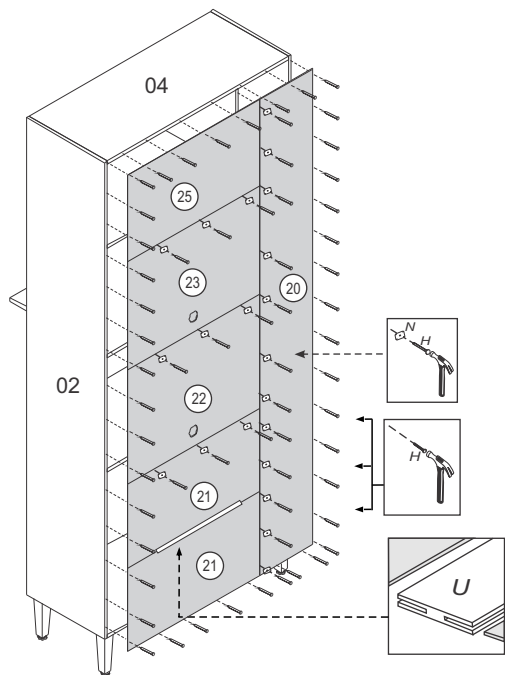

**8º Passo**  
**8º Paso**  
**8º Step**

Montagem das dobradiças nas portas (17,18,19) colocando calço e dobradiça.  
 Montaje de las bisagras en las puertas (17,18,19) Poner la base y bisagra.  
 The assembly of the Hinge in the door (17,18,19) putting the base of Hinge and hinge .

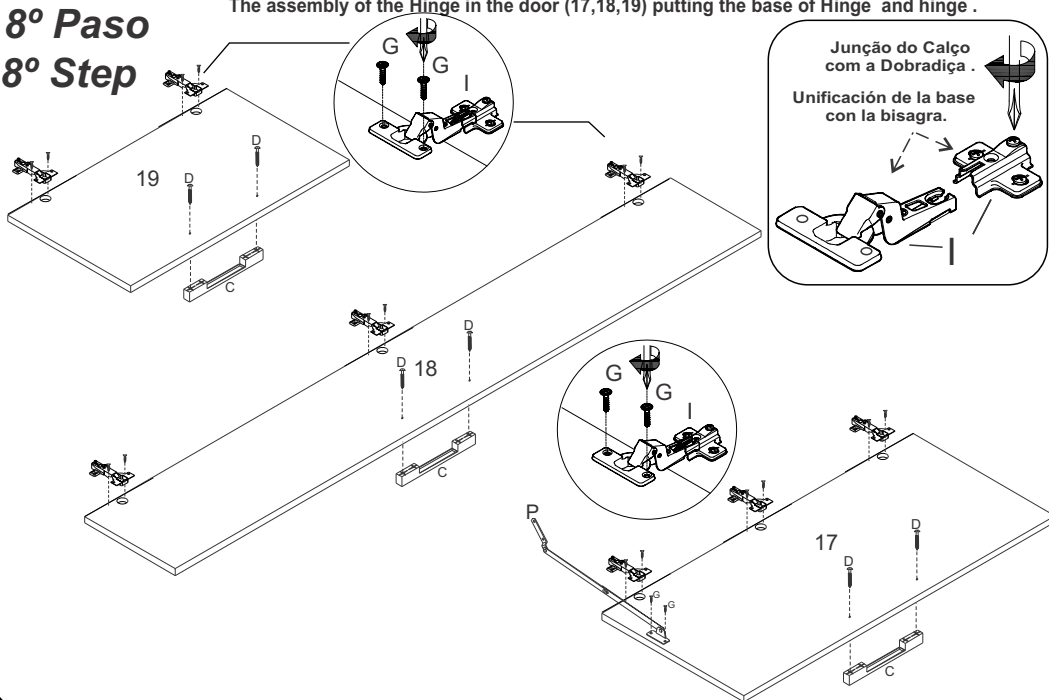

**9º Passo**  
**9º Paso**  
**9º Step**

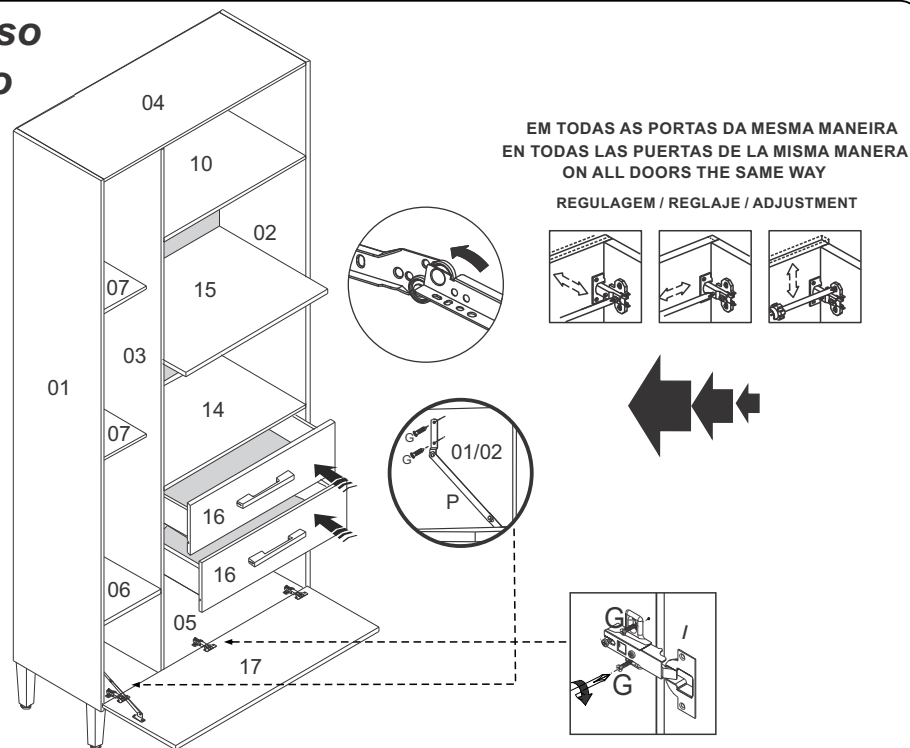

**10º Passo**  
**10º Paso**  
**10º Step**

EM TODAS AS PORTAS DA MESMA MANEIRA  
 EN TODAS LAS PUERTAS DE LA MISMA MANERA  
 ON ALL DOORS THE SAME WAY

REGULAGEM / REGLAJE / ADJUSTMENT

